

313, AMBER, SCOTTVILLE, MI, 49454
https://tuckerbenner.com

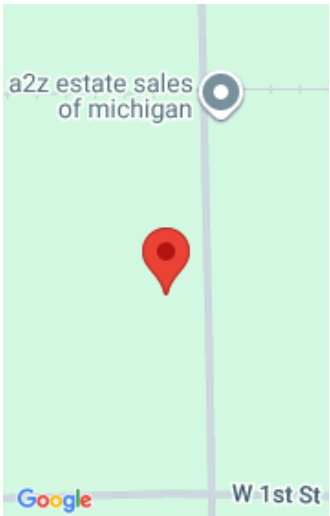

Own a Page of Mason County History: The Schoolhouse Dream Historic Charm, Modern Dream! Don't miss your chance to own a beautifully renovated schoolhouse with 14-foot ceilings and character you simply won't find anywhere else. Everything is fresh: newer windows, doors, and roof mean stress-free living. With an open-concept floor plan and a completely blank [...]

- 1 bed
- 1 bath
- Single Family Residence
- Residential
- Active
- 1296 sq ft



Call us now

Phone: (231)730-8781
Email: tuckerbennerteam@gmail.com
Address: 2747 Lakeshore Drive, Twin Lake, MI 49457

Basics

Category: Residential	Type: Single Family Residence
Status: Active	Bedrooms: 1 bed
Bathrooms: 1 bath	Area: 1296 sq ft
Lot size: 1 sq ft	Year built: 1900
Bathrooms Full: 1	Lot Size Acres: 1 acres
Rooms Total: 3	County: Mason

Building Details

Building Area Total: 1296 sq ft	Construction Materials: Aluminum Siding
Architectural Style: Other	Sewer: Septic Tank
Heating: Forced Air	Stories: 1
Basement: Slab	

Amenities & Features

Laundry Features: Laundry Closet	WaterSource: Well
Patio And Porch Features: Deck	

Fees & Taxes

Tax Assessed Value: \$39,217	Tax Year: 2025
Tax Annual Amount: \$1,107	

School Information

Call us now

High School District: Mason Cnty Central

Middle Or Junior School: Mason County Central Middle School

HighSchool: Mason County Central High School

Elementary School: Mason County Central Upper Elementary School

Miscellaneous

Road Surface Type: Paved

CrossStreet: 1st St

Listing Terms: Cash, FHA, VA Loan, Rural Development, Conventional

Call us now