

313, MAIN, KENT CITY, MI, 49330

https://tuckerbenner.com

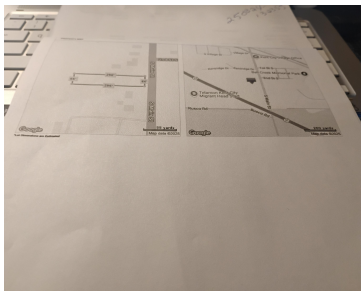
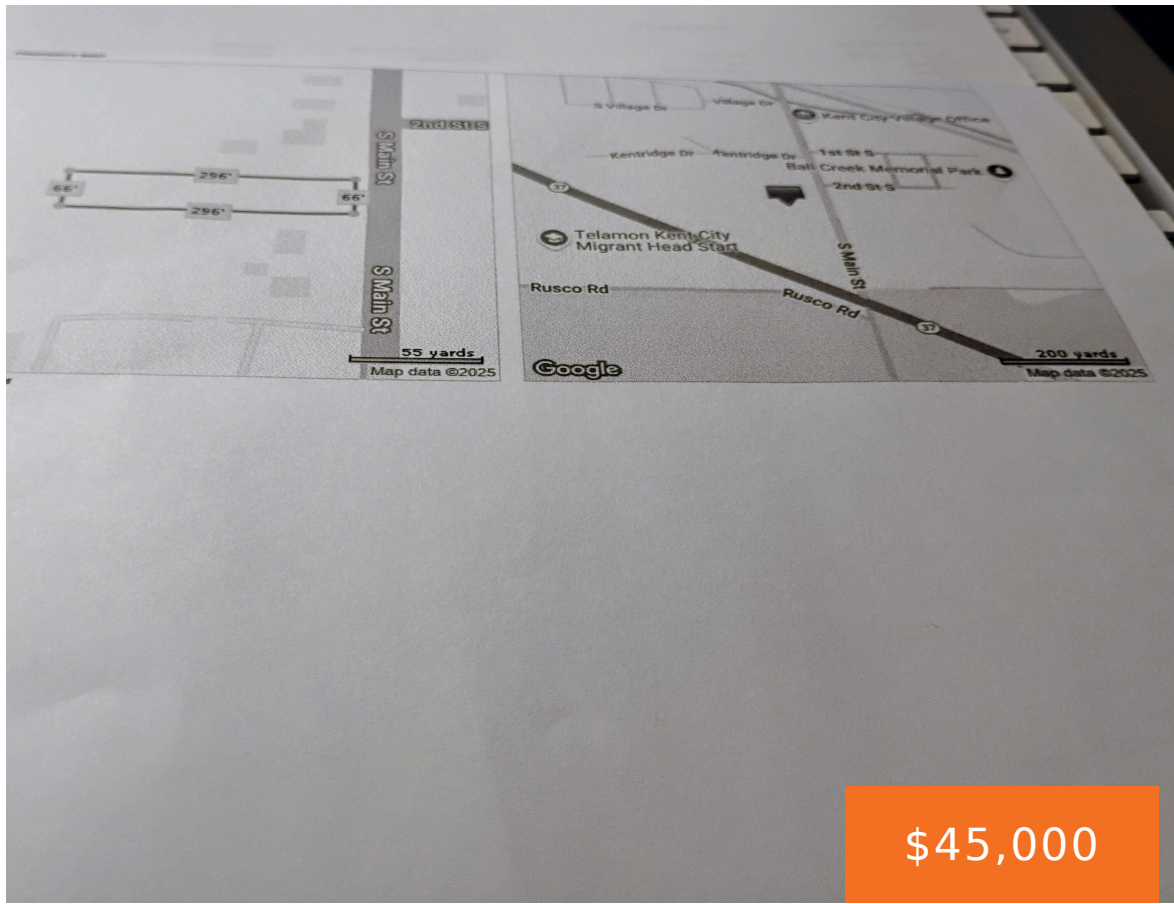

Deep Lot in the Village of Kent City. Drive by for a look.

- 0 baths
- Lot
- Land
- Active



Basics

Category: Land

Status: Active

Lot size: 0.5 sq ft

County: Kent

Type: Lot

Bathrooms: 0 baths

Lot Size Acres: 0.5 acres



Call us now

Phone: (231)730-8781
 Email: tuckerbennerteam@gmail.com
 Address: 2747 Lakeshore Drive, Twin Lake, MI 49457



Amenities & Features

Utilities: Electricity Available, None

Lot Features: Level

Fees & Taxes

Tax Assessed Value: \$12,180

Tax Year: 2024

Tax Annual Amount: \$377

School Information

High School District: Kent City

Miscellaneous

Road Surface Type: Paved

CrossStreet: M-37

Listing Terms: Cash



Call us now

Phone: (231)730-8781

Email: tuckerbennerteam@gmail.com

Address: 2747 Lakeshore Drive, Twin Lake, MI 49457

