

315, MICHIGAN, SALINE, MI, 48176

<https://tuckerbenner.com>

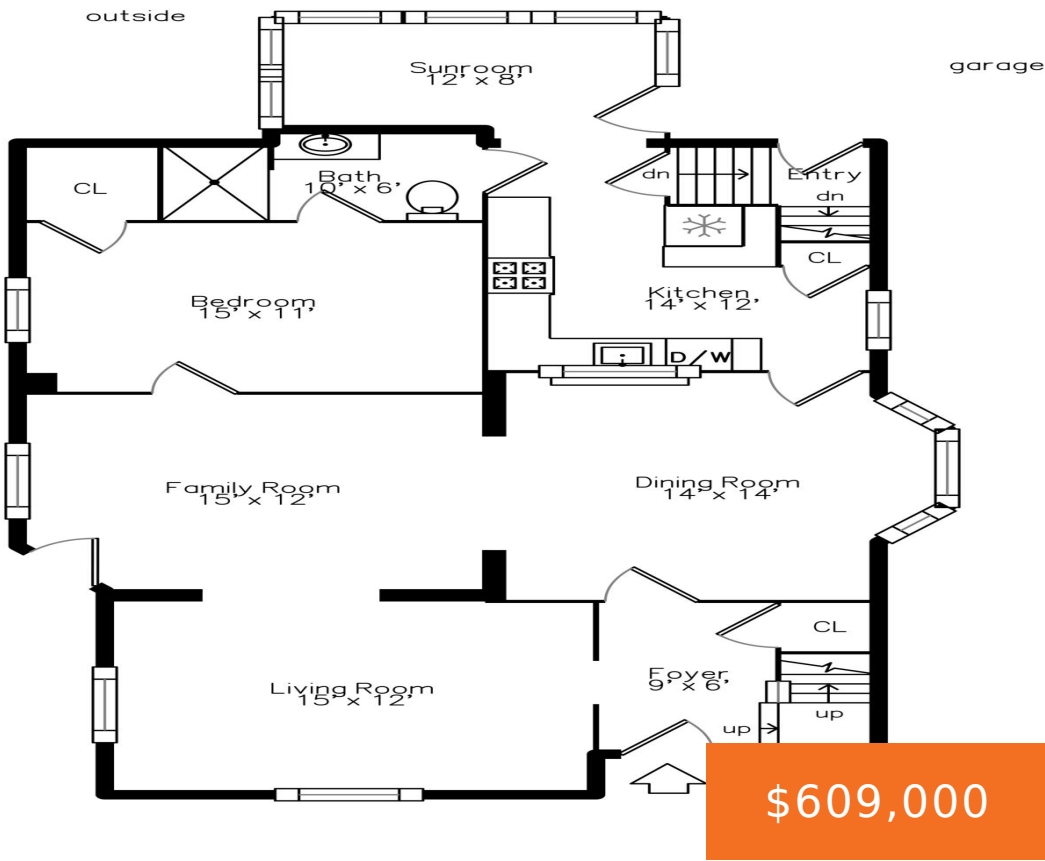

Modern convenience meets timeless charm in this beautifully maintained historic home, ideally located within walking distance to downtown Saline and just across from the city-owned Curtiss Mansion. From the inviting covered front porch, you'll enjoy a setting that blends classic character with a vibrant, walkable lifestyle. Inside, rich woodwork and thoughtful details highlight the home's [...]

- 4 beds
- 2 baths
- Single Family Residence
- Residential
- Active
- 1954 sq ft



Basics

Call us now

Phone: (231)730-8781
Email: tuckerbennerteam@gmail.com
Address: 2747 Lakeshore Drive, Twin Lake, MI 49457



Category: Residential

Status: Active

Bathrooms: 2 baths

Lot size: 0.38 sq ft

Bathrooms Full: 2

Rooms Total: 10

Type: Single Family Residence

Bedrooms: 4 beds

Area: 1954 sq ft

Year built: 1911

Lot Size Acres: 0.38 acres

County: Washtenaw

Building Details

Building Area Total: 1954 sq ft **Construction Materials:** Brick, Wood Siding

Architectural Style: Victorian **Sewer:** Public

Heating: Forced Air **Stories:** 2

Roof: Asphalt **Basement:** Full

Amenities & Features

Laundry Features: In Basement

Utilities: Phone Available, Electricity Available, Natural Gas Connected, Cable Connected, Storm Sewer, High-Speed Internet

Fireplace Features: Gas Log, Living Room

WaterSource: Public

Interior Features: Ceiling Fan(s), Garage Door Opener

Window Features: Replacement, Window Treatments

Fireplaces Total: 1

Flooring: Carpet, Ceramic Tile, Tile, Wood

Parking Features: Garage Faces Front, Detached

Garage Spaces: 2

Appliances: Dishwasher, Disposal, Dryer, Microwave, Oven, Range, Refrigerator, Washer, Water Softener Owned

Lot Features: Level, Sidewalk

Patio And Porch Features: Covered, Deck, Porch(es)

Cooling: Central Air

Fees & Taxes

Call us now



Phone: (231)730-8781

Email: tuckerbennerteam@gmail.com

Address: 2747 Lakeshore Drive, Twin Lake, MI 49457



Tax Assessed Value: \$195,081

Tax Year: 2025

Tax Annual Amount: \$9,504

School Information

High School District: Saline

HighSchool: Saline High School

Middle Or Junior School: Saline Middle School

Elementary School: Saline Elementary School

Miscellaneous

Road Surface Type: Paved

CrossStreet: Between Maple and Davenport

Listing Terms: Cash, FHA, VA Loan, Conventional

Call us now



Phone: (231)730-8781

Email: tuckerbennerteam@gmail.com

Address: 2747 Lakeshore Drive, Twin Lake, MI 49457

