

316, W WASHINGTON ST, EVART, MI, 49631

<https://tuckerbenner.com>

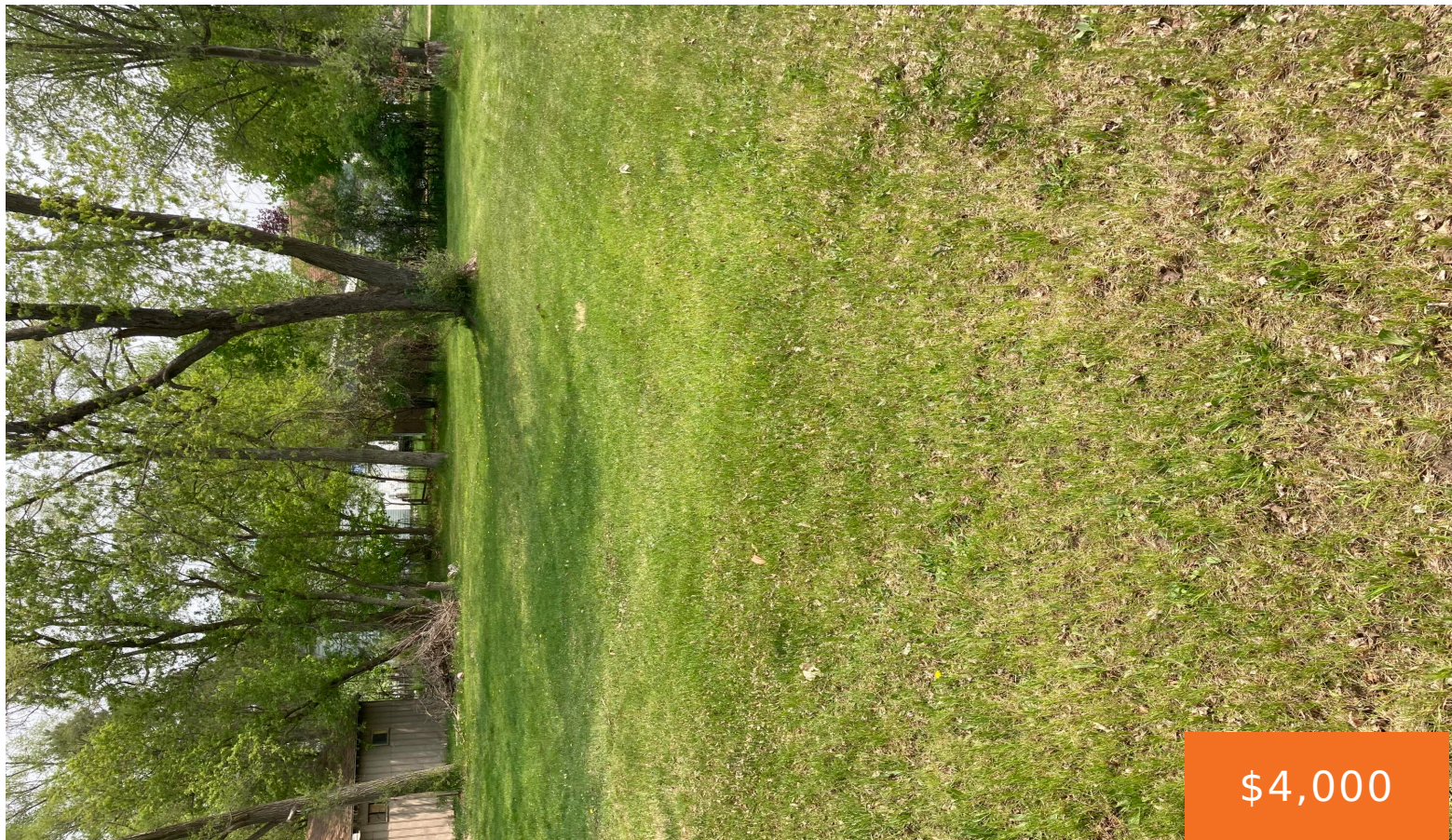

\$4,000

Buildable site on the north side of town with access to both Oak St and Washington St. This site is level and has a perfect clearing for your future home to be built. Easy access to electric, city water, city sewer, and other utilities. Come and grab your piece of land for your future home.

- 0 baths
- Acreage
- Land
- Active

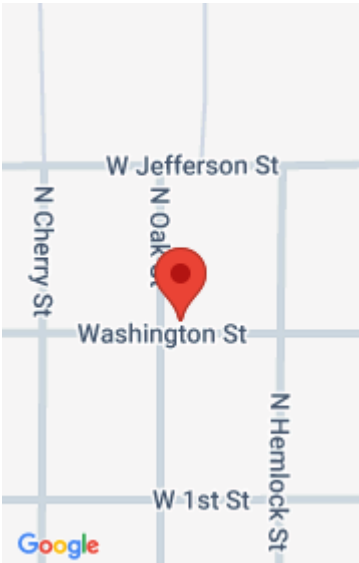

Call us now



Phone: (231)730-8781
Email: tuckerbennerteam@gmail.com
Address: 2747 Lakeshore Drive, Twin Lake, MI 49457



Basics

Category: Land

Status: Active

Lot size: 0.15 sq ft

County: Osceola

Type: Acreage

Bathrooms: 0 baths

Lot Size Acres: 0.15 acres

Building Details

Sewer: Public Sewer

Current Use: Residential

Amenities & Features

Utilities: Natural Gas Available, Electricity Available, Cable Available, None

WaterSource: Public

Interior Features: Broadband

Lot Features: Level, Buildable, Cleared, Corner Lot

Fees & Taxes

Tax Assessed Value: \$1,452

Tax Year: 2024

Tax Annual Amount: \$80

School Information

High School District: Evert

Miscellaneous

Call us now



Phone: (231)730-8781

Email: tuckerbennerteam@gmail.com

Address: 2747 Lakeshore Drive, Twin Lake, MI 49457



Road Surface Type: Paved

CrossStreet: Oak St

Listing Terms: Cash, Conventional

Call us now



Phone: (231)730-8781
Email: tuckerbennerteam@gmail.com
Address: 2747 Lakeshore Drive, Twin Lake, MI 49457

