

3160, MICHIGAN, YPSILANTI, MI, 48197
<https://tuckerbenner.com>

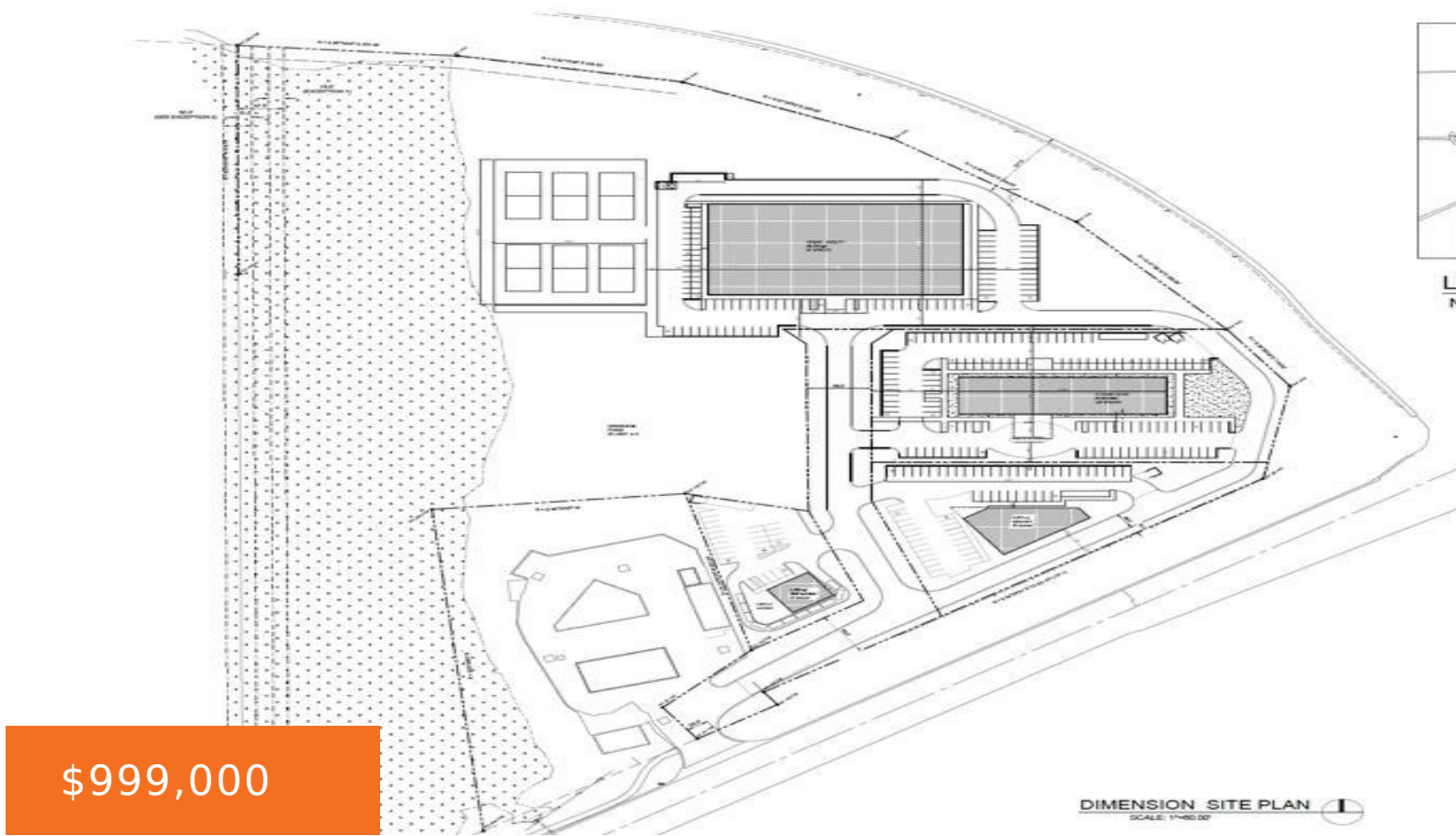

\$999,000

BETWEEN ANN ARBOR/YPSILANTI MARKETS - Located off the I-94 and Michigan Ave exit ramp, between EMU and U of M for easy access and convenience. This listing is for entire lot. 3 Pad sites available for Sale of 1-5. Pad Sites lend themselves to one Fast Food, One larger Restaurant or Retail Space and one [...]

- 0 baths
- Commercial Land
- Land
- Active



Basics

Category: Land
Status: Active
Lot size: 20.57 sq ft
County: Washtenaw

Type: Commercial Land
Bathrooms: 0 baths
Lot Size Acres: 20.57 acres



Call us now

Phone: (231)730-8781
Email: tuckerbennerteam@gmail.com
Address: 2747 Lakeshore Drive, Twin Lake, MI 49457



Building Details

Current Use: Tree Farm

Amenities & Features

Utilities: Public Water Connected, Natural Gas Connected, Electric Connected, Phone Available, Storm Sewer Available, Public Water Available, Public Sewer Available, Natural Gas Available, Electric Available, Cable Available

Lot Features: Adj to Public Land, Buildable, Wetland Area, Wooded, Corner Lot

Fees & Taxes

Tax Assessed Value: \$224,381

Tax Year: 2024

Tax Annual Amount: \$14,027

School Information

High School District: Ypsilanti

Miscellaneous

Road Surface Type: Paved

CrossStreet: I-94 and US-12

Listing Terms: Cash, Conventional



Call us now

Phone: (231)730-8781

Email: tuckerbennerteam@gmail.com

Address: 2747 Lakeshore Drive, Twin Lake, MI 49457

