

33, GEORGIA, PENTWATER, MI, 49449
https://tuckerbenner.com

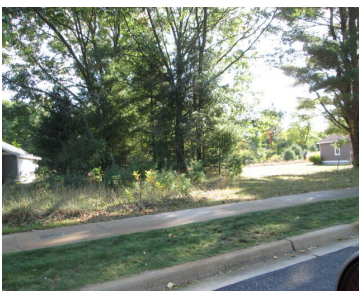

\$49,000

Nice site across the street from the park. Beautiful Association with club house, pool and exterior maintenance



- 0 baths
- Lot
- Land
- Active

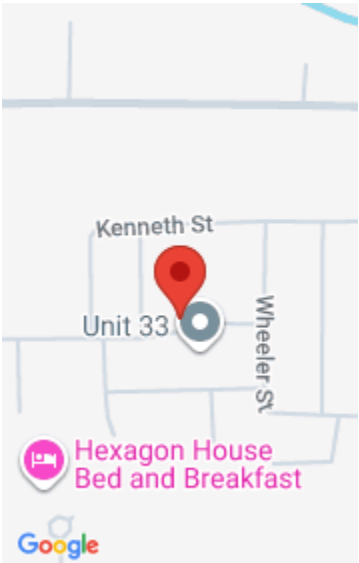

Call us now

Phone: (231)730-8781
Email: tuckerbennerteam@gmail.com
Address: 2747 Lakeshore Drive, Twin Lake, MI 49457

Basics

Category: Land

Status: Active

Lot size: 0.11 sq ft

County: Oceana

Type: Lot

Bathrooms: 0 baths

Lot Size Acres: 0.11 acres

Building Details

Current Use: Residential

Amenities & Features

Utilities: Phone Available, Storm Sewer, Water Available, Sewer Available, Natural Gas Available, Electricity Available, Cable Available, Broadband, None

Fees & Taxes

Tax Assessed Value: \$16,000

Tax Year: 2024

Tax Annual Amount: \$890

Association Fee Includes: Cable/Satellite, Lawn/Yard Care, Snow Removal

School Information

High School District: Pentwater

Miscellaneous

Call us now

 Phone: (231)730-8781

 Email: tuckerbennerteam@gmail.com

 Address: 2747 Lakeshore Drive, Twin Lake, MI 49457



Road Surface Type: Paved

CrossStreet: Clymer

Listing Terms: Cash

Call us now



Phone: (231)730-8781
Email: tuckerbennerteam@gmail.com
Address: 2747 Lakeshore Drive, Twin Lake, MI 49457

