

3314, PINE GLEN, SAUGATUCK, MI, 49453

<https://tuckerbenner.com>

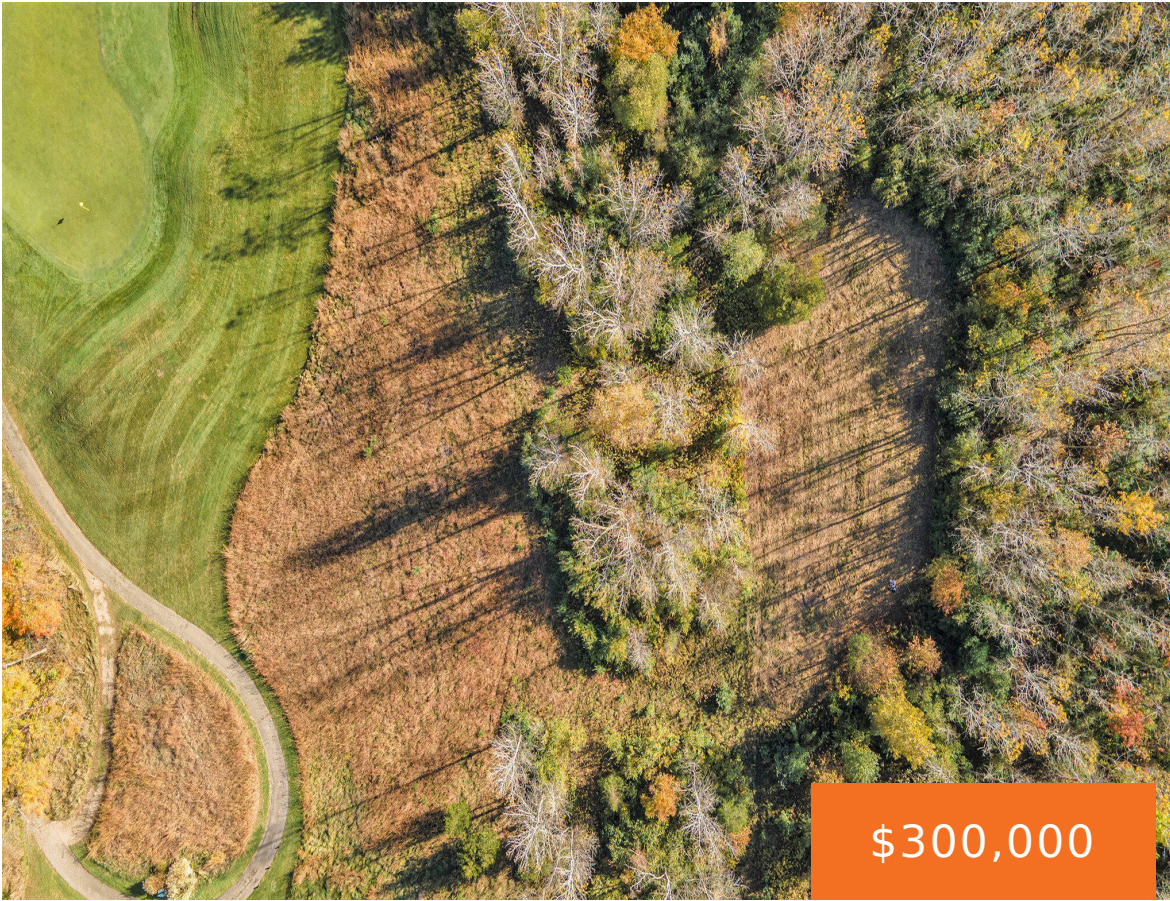

\$300,000



The Estates at Pine Glen is an exclusive residential development in Saugatuck offering picturesque views of either the 13th hole at the Ravines Golf Club or the serene pond. With only 8 lots on 35 acres, each property is carefully engineered and designed to maximize these stunning natural surroundings. Only 5 of the 8 lots [...]

- 0 baths
- Acreage
- Land
- Active



Basics

Category: Land

Status: Active

Lot size: 3.68 sq ft

Lot Size Acres: 3.68 acres

Type: Acreage

Bathrooms: 0 baths

Subdivision Name: Estates at Pine Glen

County: Allegan



Call us now

Phone: (231)730-8781
 Email: tuckerbennerteam@gmail.com
 Address: 2747 Lakeshore Drive, Twin Lake, MI 49457



Amenities & Features

Utilities: Phone Available,
None

Lot Features: Buildable, Cleared, Cul-De-Sac, Golf Course
Frontage, Wooded

Fees & Taxes

Tax Assessed Value: \$109,597

Tax Year: 2023

Tax Annual Amount: \$5,411.97

School Information

High School District: Hamilton

Miscellaneous

CrossStreet: Old Allegan Rd. & 133rd.

Listing Terms: Cash, Conventional



Call us now

Phone: (231)730-8781

Email: tuckerbennerteam@gmail.com

Address: 2747 Lakeshore Drive, Twin Lake, MI 49457

