

3406, SHORE, BATTLE CREEK, MI, 49017

https://tuckerbenner.com

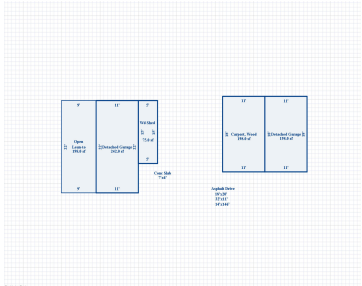

Great opportunity to purchase this 7.375 acre, 2 bedroom home with 2 outbuildings including a mancave with electricity! The home has a newer roof, good sized kitchen and bath, main floor laundry, and covered front porch. The property is gorgeous and public access is right around the corner. This definitely a great year round home [...]

- 2 beds
- 1 bath
- Single Family Residence
- Residential
- Active
- 1144 sq ft



Basics

Call us now



Phone: (231)730-8781
 Email: tuckerbennerteam@gmail.com
 Address: 2747 Lakeshore Drive, Twin Lake, MI 49457



Category: Residential

Status: Active

Bathrooms: 1 bath

Lot size: 1.38 sq ft

Bathrooms Full: 1

Rooms Total: 6

Type: Single Family Residence

Bedrooms: 2 beds

Area: 1144 sq ft

Year built: 1940

Lot Size Acres: 1.38 acres

County: Barry

Building Details

Building Area Total: 1144 sq ft

Architectural Style: Ranch

Heating: Forced Air

Roof: Composition

Construction Materials: Aluminum Siding

Sewer: Septic Tank

Stories: 1

Basement: Slab

Amenities & Features

Laundry Features: Main Level

Parking Features: Detached

WaterSource: Well

Lot Features: Wooded, Rolling Hills

Patio And Porch Features: Covered, Porch(es)

Flooring: Carpet, Vinyl

Garage Spaces: 1

Appliances: Dryer, Range, Refrigerator, Washer

Window Features: Replacement

Exterior Features: Other

Fees & Taxes

Tax Assessed Value: \$63,426

Tax Annual Amount: \$3,032

Tax Year: 2025

School Information

Call us now



Phone: (231)730-8781

Email: tuckerbennerteam@gmail.com

Address: 2747 Lakeshore Drive, Twin Lake, MI 49457



High School District: Delton-Kellogg

Miscellaneous

Road Surface Type: Paved

CrossStreet: West Shore and Hickory

Listing Terms: Cash, Conventional

Call us now



Phone: (231)730-8781

Email: tuckerbennerteam@gmail.com

Address: 2747 Lakeshore Drive, Twin Lake, MI 49457

