

West Haven

A DELOOF DEVELOPMENT

DELOOF BUILDERS L.L.C.

- UNDERGROUND UTILITIES
- ADJACENT TO KAL HAVEN TRAIL
- EXPERT CONSTRUCTION
- HALF ACRE + LOTS
- WALKOUT & DAYLIGHT WINDOW LOTS

 Find us on Facebook

269-375-0344 www.delooftbuilders.com

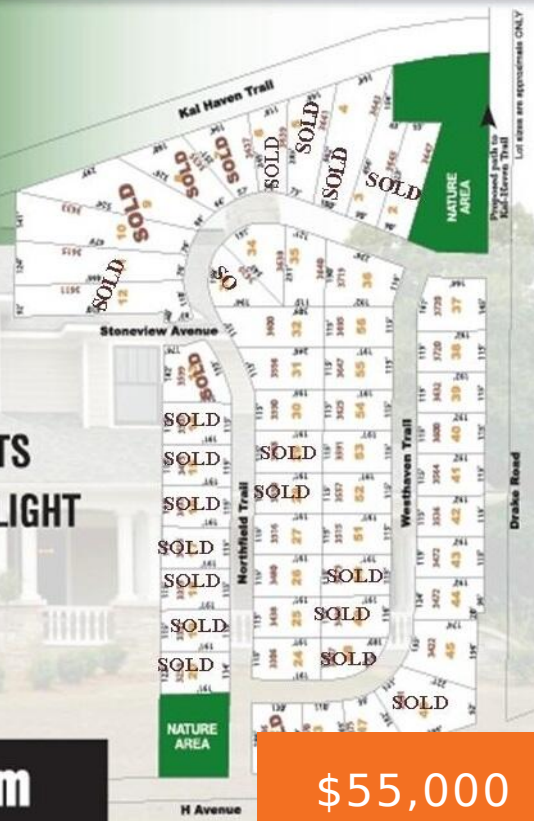

\$55,000

- 0 baths
- Lot
- Land
- Active

Basics

Category: Land

Status: Active

Lot size: 0.46 sq ft

County: Kalamazoo

Type: Lot

Bathrooms: 0 baths

Lot Size Acres: 0.46 acres

Call us now

Phone: (231)730-8781
 Email: tuckerbennerteam@gmail.com
 Address: 2747 Lakeshore Drive, Twin Lake, MI 49457

Building Details

Sewer: Public Sewer

Amenities & Features

Utilities: Natural Gas Available, Electricity Available, Cable Available, Phone Connected, Natural Gas Connected, Phone Available, Storm Sewer, Electricity Connected

WaterSource: Public

Lot Features: Buildable

Fees & Taxes

Tax Assessed Value: \$2,436

Tax Year: 2025

Tax Annual Amount: \$100

School Information

High School District: Kalamazoo

Miscellaneous

Road Surface Type: Paved

CrossStreet: 12th strete and H avenue

Listing Terms: Cash, Conventional, Contract

Call us now



Phone: (231)730-8781

Email: tuckerbennerteam@gmail.com

Address: 2747 Lakeshore Drive, Twin Lake, MI 49457

