

# West Haven

A DELOOF DEVELOPMENT

## DELOOF BUILDERS L.L.C.

- UNDERGROUND UTILITIES
- ADJACENT TO KAL HAVEN TRAIL
- EXPERT CONSTRUCTION
- HALF ACRE + LOTS
- WALKOUT & DAYLIGHT WINDOW LOTS

 Find us on Facebook

269-375-0344 [www.deloofbuilders.com](http://www.deloofbuilders.com)

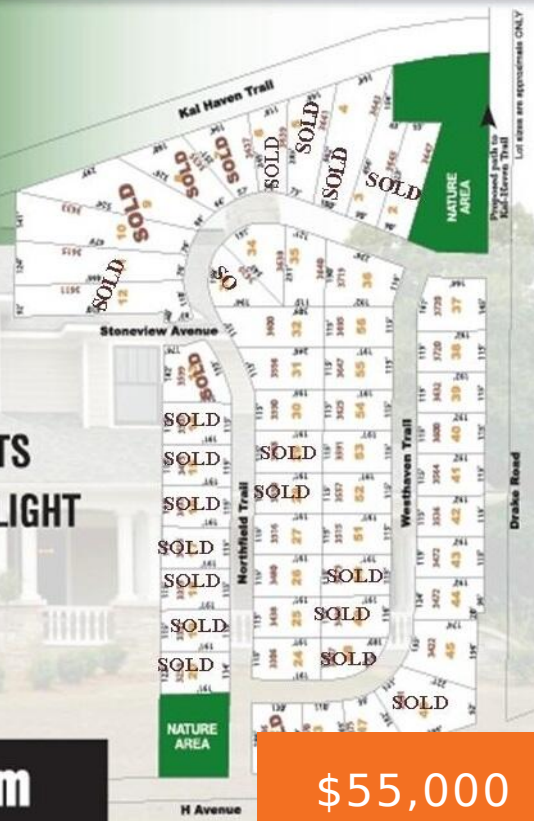

\$55,000

- 0 baths
- Lot
- Land
- Active

### Basics

**Category:** Land

**Status:** Active

**Lot size:** 0.57 sq ft

**Lot Size Acres:** 0.57 acres

**Type:** Lot

**Bathrooms:** 0 baths

**Subdivision Name:** Westhaven

**County:** Kalamazoo

### Call us now

Phone: (231)730-8781  
 Email: [tuckerbennerteam@gmail.com](mailto:tuckerbennerteam@gmail.com)  
 Address: 2747 Lakeshore Drive, Twin Lake, MI 49457

---

## Building Details

**Sewer:** Public Sewer

---

## Amenities & Features

**Utilities:** Natural Gas Available, Electricity Available, Cable Available, Phone Connected, Natural Gas Connected, Phone Available, Storm Sewer, Electricity Connected

**WaterSource:** Public

---

## Fees & Taxes

**Tax Assessed Value:** \$16,100

**Tax Year:** 2022

**Tax Annual Amount:** \$100

---

## School Information

**High School District:** Kalamazoo

---

## Miscellaneous

**Road Surface Type:** Paved

**CrossStreet:** 12th Street and H Avenue

**Listing Terms:** Cash, Conventional, Contract

### Call us now



Phone: (231)730-8781

Email: tuckerbennerteam@gmail.com

Address: 2747 Lakeshore Drive, Twin Lake, MI 49457

