

37103, CR 390, GOBLES, MI, 49055

<https://tuckerbenner.com>

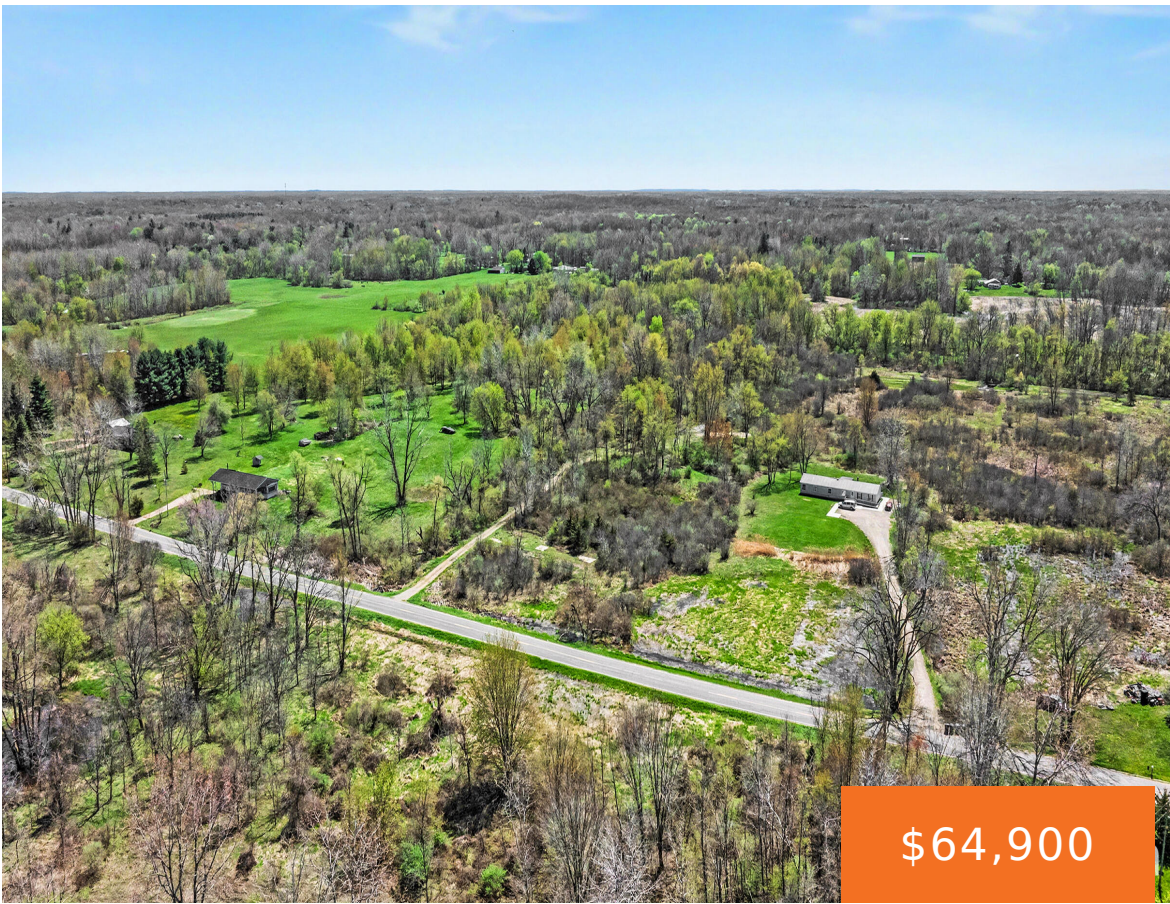

\$64,900



Just in time to enjoy the beautiful outdoors this Spring! Over 5 acres of versatile land perfectly situated for the avid hunter or outdoor enthusiast offering thick cover for hunting and plenty of room for recreational use. Power is already connected on-site saving you thousands, and making it the ultimate setup for your basecamp. Quiet, [...]

- 0 baths
- Acreage
- Land
- Active

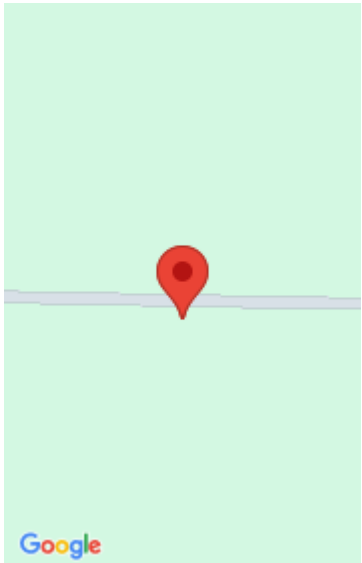

Call us now

Phone: (231)730-8781
Email: tuckerbennerteam@gmail.com
Address: 2747 Lakeshore Drive, Twin Lake, MI 49457



Basics

Category: Land

Status: Active

Lot size: 5.29 sq ft

County: Van Buren

Type: Acreage

Bathrooms: 0 baths

Lot Size Acres: 5.29 acres

Building Details

Current Use: Recreational, Hunting, Agricultural

Amenities & Features

Utilities: Electricity Available, Electricity Connected

Lot Features: Wooded

Fees & Taxes

Tax Assessed Value: \$10,430

Tax Year: 2025

Tax Annual Amount: \$560.95

School Information

High School District: Gobles

Miscellaneous

Road Surface Type: Paved

CrossStreet: 4th Ave & 36th St

Listing Terms: Cash, Conventional

Call us now



Phone: (231)730-8781

Email: tuckerbennerteam@gmail.com

Address: 2747 Lakeshore Drive, Twin Lake, MI 49457

