

3716, MARABELLA, KALAMAZOO, MI, 49006

https://tuckerbenner.com

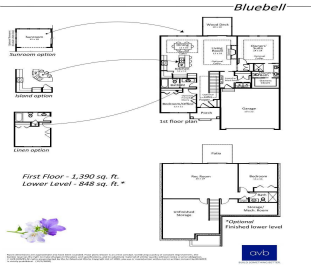

\$429,900



Welcome to Walden Woods, an 80-acre master-planned community nestled in 40 acres of lush greenspace. Immerse yourself in the tranquility of walking trails & indulge in the amenities of our gorgeous clubhouse - complete with meeting rooms, a patio, kitchen, and pool. As you arrive, the beautifully landscaped boulevard beckons you home. Step inside this [...]

- 2 beds
- 2 baths
- Condominium
- Residential
- Active
- 1390 sq ft



### Basics



### Call us now

Phone: (231)730-8781  
 Email: tuckerbennerteam@gmail.com  
 Address: 2747 Lakeshore Drive, Twin Lake, MI 49457



**Category:** Residential

**Status:** Active

**Bathrooms:** 2 baths

**Lot size:** 0.07 sq ft

**Subdivision Name:** Walden Woods

**Lot Size Acres:** 0.07 acres

**County:** Kalamazoo

**Type:** Condominium

**Bedrooms:** 2 beds

**Area:** 1390 sq ft

**Year built:** 2024

**Bathrooms Full:** 2

**Rooms Total:** 8

---

## Building Details

**Building Area Total:** 1390 sq ft

**Architectural Style:** Ranch

**Heating:** Forced Air

**Basement:** Other, Walk Out

**Construction Materials:** Vinyl Siding

**Sewer:** Public Sewer

**Stories:** 1

---

## Amenities & Features

**Laundry Features:** Gas Dryer Hookup, Laundry Room, Main Level, Washer Hookup

**Association Amenities:** Walking Trails, Pets Allowed, Club House, Fitness Center, Meeting Room, Pool

**Garage Spaces:** 2

**Appliances:** Disposal, Dishwasher, Microwave, Range, Refrigerator

**Lot Features:** Level, Sidewalk

**Exterior Features:** Patio, Deck(s)

**Utilities:** Phone Available, Storm Sewer, Public Water, Public Sewer, Natural Gas Available, Electricity Available, Cable Available, Broadband, Natural Gas Connected

**Parking Features:** Garage Faces Front, Garage Door Opener, Attached

**WaterSource:** Public

**Interior Features:** Garage Door Opener, Humidifier, Laminate Floor, Kitchen Island, Pantry

**Window Features:** Screens, Low Emissivity Windows, Insulated Windows

**Cooling:** Central Air

---

## Fees & Taxes



### Call us now

Phone: (231)730-8781

Email: tuckerbennerteam@gmail.com

Address: 2747 Lakeshore Drive, Twin Lake, MI 49457



**Tax Assessed Value:** \$1,834

**Association Fee Frequency:**  
Monthly

**Association Fee:** \$370

**Tax Year:** 2023

**Association Fee Includes:** Trash, Snow Removal,  
Lawn/Yard Care

---

## School Information

**High School District:** Kalamazoo

**HighSchool:** Kalamazoo Central

**Middle Or Junior School:** Linden Grove  
Elementary

**Elementary School:** Northglade Montessori  
Magnet

---

## Miscellaneous

**Road Surface Type:** Paved

**CrossStreet:** Arboretum/Thoreau's Woods

**Listing Terms:** Cash, Conventional



### Call us now

Phone: (231)730-8781

Email: [tuckerbennerteam@gmail.com](mailto:tuckerbennerteam@gmail.com)

Address: 2747 Lakeshore Drive, Twin Lake, MI 49457

