

3726, MARABELLA, KALAMAZOO, MI, 49006

<https://tuckerbenner.com>

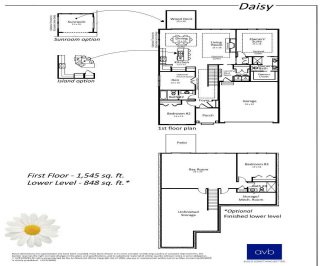

This spacious and elegant condo features 2 bedrooms and two bathrooms and 1545 square feet of living space on the main floor. The option of adding a finished lower level walkout adding an additional 848 square feet of living space. The open floor plan boasts a designer kitchen with granite countertops, stainless steel appliances, and [...]

- 2 beds
- 2 baths
- Condominium
- Residential
- Active
- 1545 sq ft



Basics



Call us now

Phone: (231)730-8781
 Email: tuckerbennerteam@gmail.com
 Address: 2747 Lakeshore Drive, Twin Lake, MI 49457



Category: Residential

Status: Active

Bathrooms: 2 baths

Lot size: 0.07 sq ft

Subdivision Name: Walden Woods

Lot Size Acres: 0.07 acres

County: Kalamazoo

Type: Condominium

Bedrooms: 2 beds

Area: 1545 sq ft

Year built: 2024

Bathrooms Full: 2

Rooms Total: 9

Building Details

Building Area Total: 1545 sq ft

Architectural Style: Ranch

Heating: Forced Air

Common Walls: End Unit

Construction Materials: Vinyl Siding

Sewer: Public Sewer

Stories: 1

Basement: Other, Walk Out

Amenities & Features

Laundry Features: Gas Dryer Hookup, Laundry Room, Main Level, Washer Hookup

Association Amenities: Club House, Fitness Center, Meeting Room, Pool

Fireplace Features: Family, Gas Log

WaterSource: Public

Interior Features: Ceiling Fans, Garage Door Opener, Humidifier, Laminate Floor, Kitchen Island, Pantry

Window Features: Screens, Low Emissivity Windows, Insulated Windows

Fireplaces Total: 1

Utilities: Storm Sewer, Public Water, Public Sewer, Natural Gas Available, Electricity Available, Cable Available, Broadband, Natural Gas Connected

Parking Features: Attached

Garage Spaces: 2

Appliances: Disposal, Dishwasher, Microwave, Range, Refrigerator

Lot Features: Level, Sidewalk

Exterior Features: Porch(es), Patio, Deck(s)

Cooling: Central Air



Call us now

Phone: (231)730-8781

Email: tuckerbennerteam@gmail.com

Address: 2747 Lakeshore Drive, Twin Lake, MI 49457



Fees & Taxes

Tax Assessed Value: \$2,881

Association Fee Frequency:
Monthly

Association Fee: \$370

Tax Year: 2023

Association Fee Includes: Trash, Snow Removal,
Lawn/Yard Care

School Information

High School District: Kalamazoo

HighSchool: Kalamazoo Central

Middle Or Junior School: Linden Grove

Elementary School: Northglade Montessori Magnet

Miscellaneous

Road Surface Type: Paved

CrossStreet: Wetherington Pointe & Alianca

Listing Terms: Cash, Conventional



Call us now

Phone: (231)730-8781

Email: tuckerbennerteam@gmail.com

Address: 2747 Lakeshore Drive, Twin Lake, MI 49457

