

# 3745, LAKE BLUFF, GRASS LAKE, MI, 49240

https://tuckerbenner.com

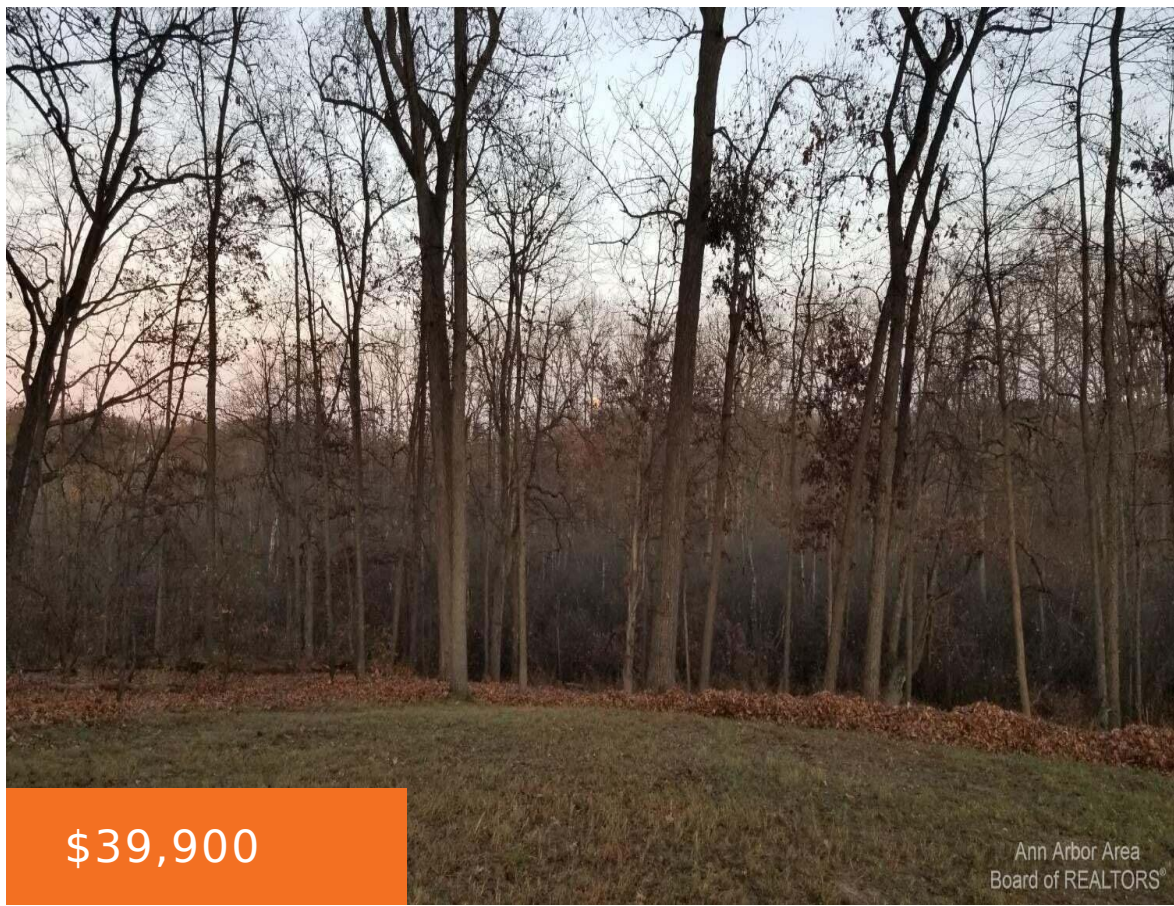

Start your summer build plans now with this beautiful one acre building site in the Tims Lake Development of Grass Lake. This lot is cleared, perc approved and ready for your home build. In addition to this incredible parcel lined with mature trees you also will have access to Tims Lake and the common area [...]

- 0 baths
- Lot
- Land
- Active



## Basics

**Category:** Land

**Status:** Active

**Lot size:** 1.07 sq ft

**Lot Size Acres:** 1.07 acres

**Type:** Lot

**Bathrooms:** 0 baths

**Subdivision Name:** Tims Lake Preserve

**County:** Jackson



### Call us now

Phone: (231)730-8781

Email: tuckerbennerteam@gmail.com

Address: 2747 Lakeshore Drive, Twin Lake, MI 49457



---

## Amenities & Features

**Utilities:** None Connected, Natural Gas Available, Electric Available

**Waterfront Features:** Assoc Access, Dock

**Association Amenities:** Beach Area, Boat Launch

**Lot Features:** Site Condo, Buildable, Building, Cleared, Wooded

---

## Fees & Taxes

**Tax Assessed Value:** \$13,100 **Association Fee Frequency:** Quarterly

**Association Fee:** \$106.30 **Tax Year:** 2023

**Tax Annual Amount:** \$690

---

## School Information

**High School District:** Grass Lake

---

## Miscellaneous

**CrossStreet:** Knight Rd

**Attribution Contact:** reBrokerBrad@gmail.com

**Listing Terms:** Cash, Conventional



### Call us now

Phone: (231)730-8781

Email: tuckerbennerteam@gmail.com

Address: 2747 Lakeshore Drive, Twin Lake, MI 49457

