

385, BURTON, BENTON HARBOR, MI, 49022

<https://tuckerbenner.com>

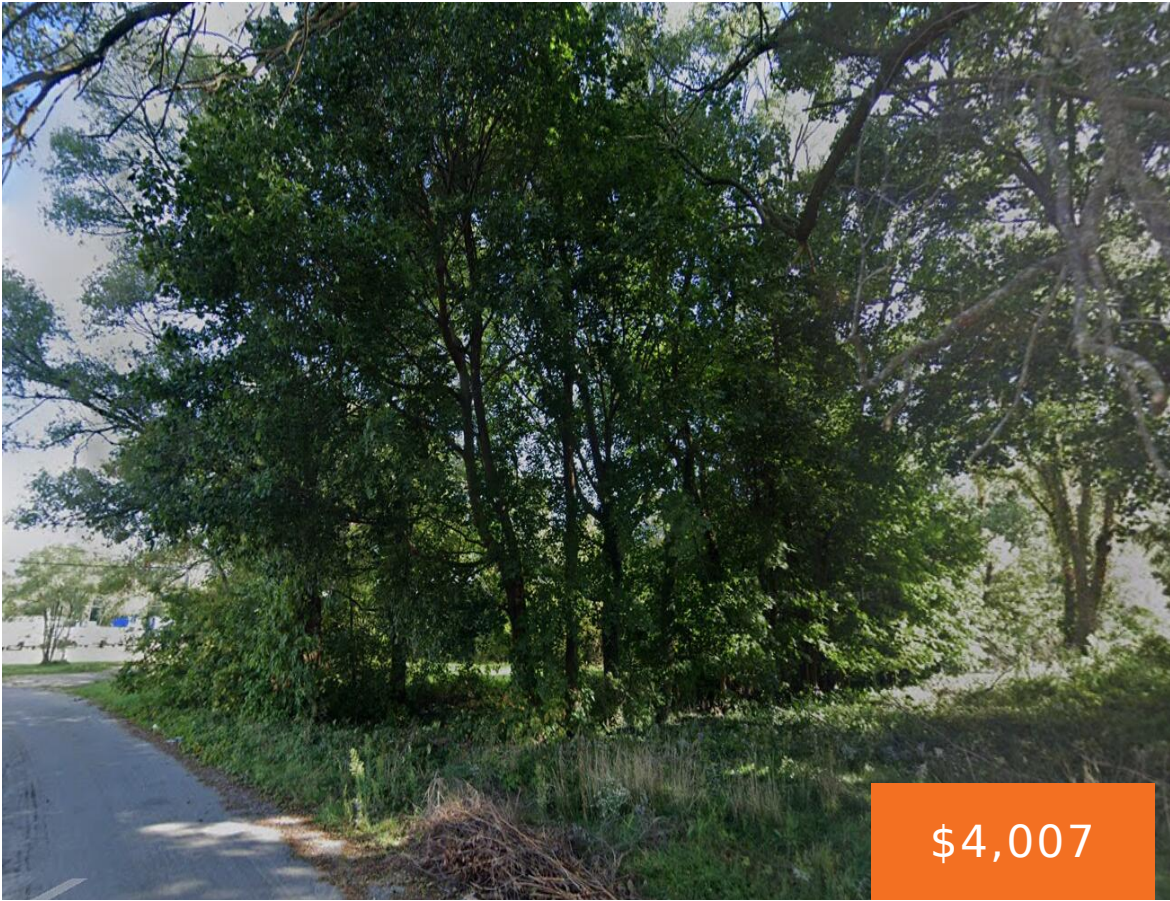

385 Burton St, Benton Harbor, MI, is a spacious 10,019 sq ft lot located just minutes from Lake Michigan. This property offers a fantastic opportunity for building your dream home or investment project. Nestled in a peaceful neighborhood, it provides easy access to nearby beaches, outdoor activities, and the conveniences of Benton Harbor.

- 0 baths
- Lot
- Land
- Active



Basics

Category: Land

Status: Active

Lot size: 0.23 sq ft

County: Berrien

Type: Lot

Bathrooms: 0 baths

Lot Size Acres: 0.23 acres



Call us now

Phone: (231)730-8781
Email: tuckerbennerteam@gmail.com
Address: 2747 Lakeshore Drive, Twin Lake, MI 49457



Building Details

Current Use: Residential

Amenities & Features

Utilities: Phone Available, Water Available, Sewer Available, None

Lot Features: Level, Buildable

Fees & Taxes

Tax Assessed Value: \$178

Tax Year: 2024

Tax Annual Amount: \$6

School Information

High School District: Benton Harbor

Miscellaneous

Road Surface Type: Paved

CrossStreet: Territorial Rd and Burton St

Listing Terms: Cash, Conventional



Call us now

Phone: (231)730-8781

Email: tuckerbennerteam@gmail.com

Address: 2747 Lakeshore Drive, Twin Lake, MI 49457

