

# 3960, M 63, BENTON HARBOR, MI, 49022

<https://tuckerbenner.com>

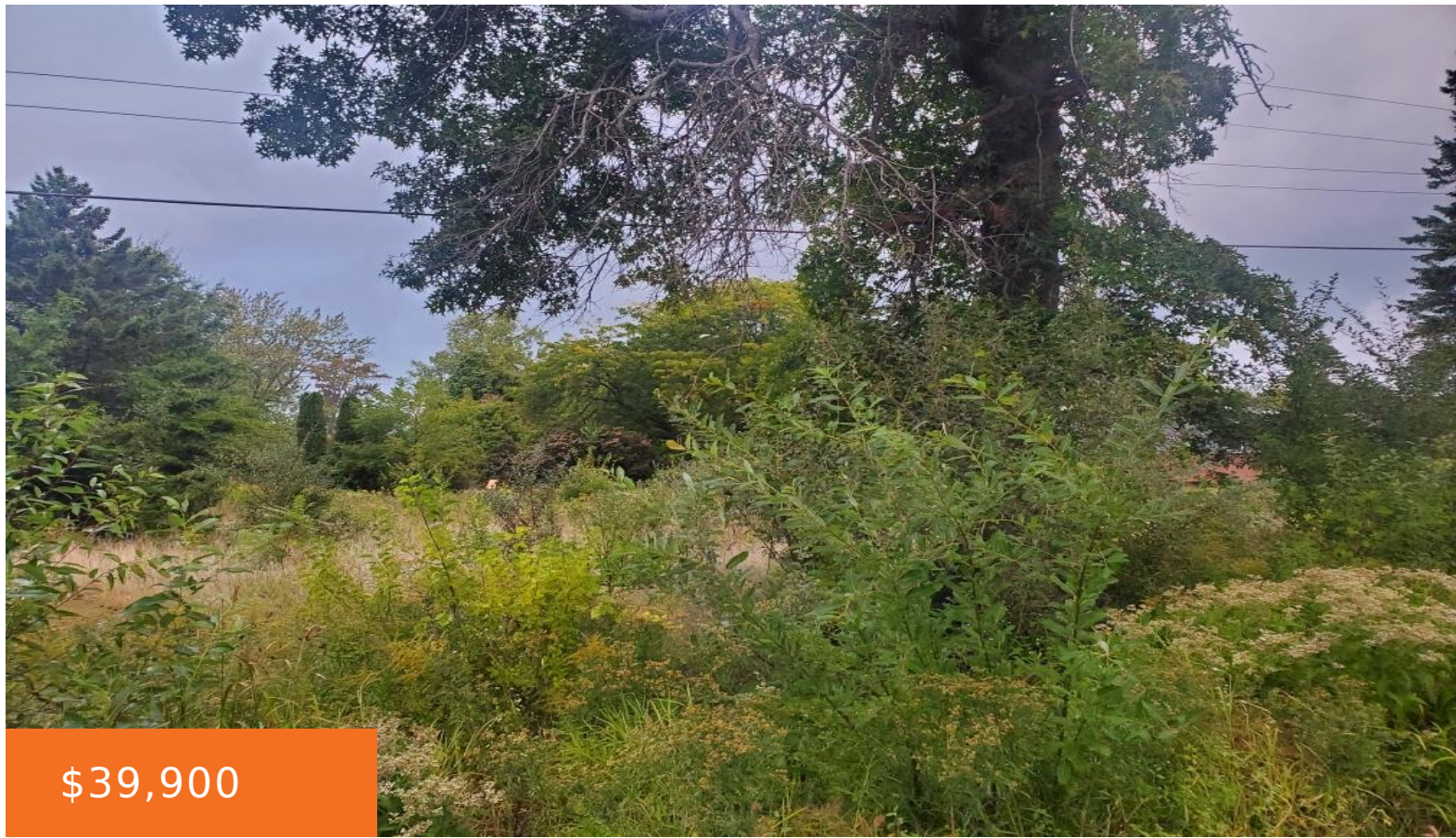

\$39,900

Great building location, close to Rocky Gap Beach, Harbor Shores Golf Course and moments from downtown St. Joe

- 0 baths
- Lot
- Land
- Active



## Basics

**Category:** Land

**Status:** Active

**Lot size:** 0.37 sq ft

**Lot Size Acres:** 0.37 acres

**Type:** Lot

**Bathrooms:** 0 baths

**Subdivision Name:** Lake Breeze

**County:** Berrien



### Call us now

Phone: (231)730-8781

Email: [tuckerbennerteam@gmail.com](mailto:tuckerbennerteam@gmail.com)

Address: 2747 Lakeshore Drive, Twin Lake, MI 49457



---

## Amenities & Features

**Lot Features:** Buildable

---

## Fees & Taxes

**Tax Assessed Value:** \$4,100

**Tax Year:** 2021

**Tax Annual Amount:** \$231

---

## School Information

**High School District:** Coloma

---

## Miscellaneous

**CrossStreet:** Lake Terrace & Coloma Rd

**Listing Terms:** Cash, Conventional



### Call us now

Phone: (231)730-8781

Email: [tuckerbennerteam@gmail.com](mailto:tuckerbennerteam@gmail.com)

Address: 2747 Lakeshore Drive, Twin Lake, MI 49457

