

399, BALDWIN, BALDWIN, MI, 49304
https://tuckerbenner.com

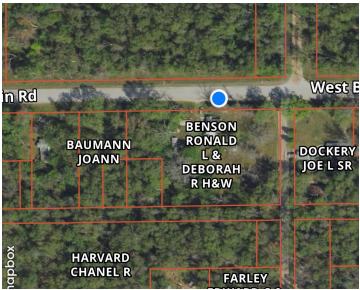

Looking for a project? This would be a great starter home or a rental. There is 1.3 acres with easy access off of Baldwin Road. Great recreational area. Bring your camper and plug into the electric, use the well and septic and work on the home. Close to 100 of acres of public land, the [...]

- 2 beds
- 1 bath
- Single Family Residence
- Residential
- Active
- 800 sq ft



Call us now

Phone: (231)730-8781
Email: tuckerbennerteam@gmail.com
Address: 2747 Lakeshore Drive, Twin Lake, MI 49457

Basics

Category: Residential

Status: Active

Bathrooms: 1 bath

Lot size: 1.33 sq ft

Subdivision Name: Thompson's Terrace

Lot Size Acres: 1.33 acres

County: Lake

Type: Single Family Residence

Bedrooms: 2 beds

Area: 800 sq ft

Year built: 1960

Bathrooms Full: 1

Rooms Total: 5

Building Details

Building Area Total: 800 sq ft

Architectural Style: Cabin

Heating: None

Basement: Partial

Construction Materials: Wood Siding

Sewer: Septic Tank

Stories: 1

Amenities & Features

Laundry Features: Other

WaterSource: Well

Utilities: Natural Gas Connected

Lot Features: Level, Wooded

Fees & Taxes

Tax Assessed Value: \$15,993

Tax Year: 2024

School Information

High School District: Baldwin

Call us now

Miscellaneous

CrossStreet: Drexelo Ave

Attribution Contact: NancyRandall@BigRiverVentures.com

Listing Terms: Cash

Call us now



Phone: (231)730-8781
Email: tuckerbennerteam@gmail.com
Address: 2747 Lakeshore Drive, Twin Lake, MI 49457

