

4163, CORVO TRACE, KALAMAZOO, MI, 49006

<https://tuckerbenner.com>



\$469,900

This spacious and elegant townhome features 3 bedrooms, 2.5 bathrooms and 1954 square feet of living space. The open floor plan features a main level primary suite with a spa like bathroom and large walk-in closet. It also has a 2 story family room with a fireplace and a wall of windows overlooking the private [...]

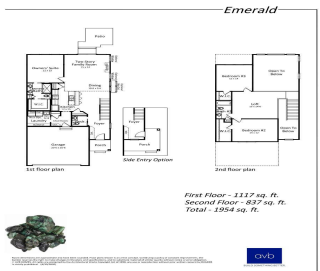

- 3 beds
- 3 baths
- Condominium
- Residential
- Active
- 1954 sq ft



Basics



Call us now

Phone: (231)730-8781
 Email: tuckerbennerteam@gmail.com
 Address: 2747 Lakeshore Drive, Twin Lake, MI 49457



Category: Residential

Status: Active

Bathrooms: 3 baths

Lot size: 0.15 sq ft

Subdivision Name: The Enclave at Walden Woods

Lot Size Acres: 0.15 acres

County: Kalamazoo

Type: Condominium

Bedrooms: 3 beds

Area: 1954 sq ft

Year built: 2024

Bathrooms Full: 2

Rooms Total: 13

Bathrooms Half: 1

Building Details

Building Area Total: 1954 sq ft

Architectural Style: Contemporary

Heating: Forced Air, Natural Gas

Basement: Full

Construction Materials: Vinyl Siding

Sewer: Public Sewer

Stories: 2

Amenities & Features

Laundry Features: Gas Dryer Hookup, Laundry Room, Main Level, Washer Hookup

Association Amenities: Walking Trails, Pool

Fireplace Features: Gas Log, Living

WaterSource: Public

Interior Features: Ceiling Fans, Garage Door Opener, Humidifier, Kitchen Island

Window Features: Screens, Low Emissivity Windows, Insulated Windows

Fireplaces Total: 1

Utilities: Storm Sewer Available, Public Water Available, Public Sewer Available, Natural Gas Available, Electric Available, Natural Gas Connected

Parking Features: Attached, Concrete, Driveway

Garage Spaces: 2

Appliances: Disposal, Dishwasher, Microwave, Range, Refrigerator

Lot Features: Level, Sidewalk, Cul-De-Sac

Exterior Features: Patio

Cooling: Central Air

Fees & Taxes



Call us now

Phone: (231)730-8781

Email: tuckerbennerteam@gmail.com

Address: 2747 Lakeshore Drive, Twin Lake, MI 49457



Tax Assessed Value: \$1,432

Association Fee Frequency:
Monthly

Association Fee: \$280

Tax Year: 2023

Association Fee Includes: Trash, Snow Removal,
Lawn/Yard Care

School Information

High School District: Kalamazoo

Miscellaneous

CrossStreet: Thoureau's Woods/Corvo Trace

Listing Terms: Cash, Conventional



Call us now

Phone: (231)730-8781

Email: tuckerbennerteam@gmail.com

Address: 2747 Lakeshore Drive, Twin Lake, MI 49457

