

# 441, EDNA, NASHVILLE, MI, 49073

<https://tuckerbenner.com>

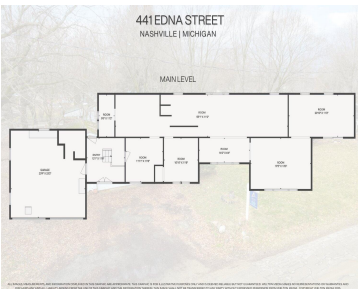

Uncover the potential in this unique property, ready to be transformed into your dream home! Nestled in a serene neighborhood, this home is set on a generous lot, offering ample space for outdoor enjoyment. Originally a trailer with add-ons, this residence has been taken down to the studs, presenting a blank canvas for your creative [...]

- 0 beds
- 0 baths
- Single Family Residence
- Residential
- Active
- 1703 sq ft



## Call us now

Phone: (231)730-8781  
Email: [tuckerbennerteam@gmail.com](mailto:tuckerbennerteam@gmail.com)  
Address: 2747 Lakeshore Drive, Twin Lake, MI 49457

# Basics

**Category:** Residential

**Status:** Active

**Bathrooms:** 0 baths

**Lot size:** 0.16 sq ft

**Subdivision Name:** hardendorf

**Rooms Total:** 6

**Type:** Single Family Residence

**Bedrooms:** 0 beds

**Area:** 1703 sq ft

**Year built:** 1900

**Lot Size Acres:** 0.16 acres

**County:** Barry

# Building Details

**Building Area Total:** 1703 sq ft

**Architectural Style:** Ranch

**Heating:** Forced Air

**Roof:** Asphalt

**Construction Materials:** Wood Siding

**Sewer:** Public Sewer

**Stories:** 1

**Basement:** Crawl Space

# Amenities & Features

**Laundry Features:** Main Level

**Utilities:** Phone Available, Natural Gas Available, Cable Available, Natural Gas Connected

**Parking Features:** Attached

**Fireplace Features:** Wood Burning

**Garage Spaces:** 2

**WaterSource:** Well

# Fees & Taxes

**Tax Assessed Value:** \$48,200

**Tax Year:** 2024

**Tax Annual Amount:** \$2,231.65

# School Information

Call us now

**High School District:** Maple Valley

**Miscellaneous**

**Road Surface Type:** Paved

**CrossStreet:** edna and gregg

**Listing Terms:** Other, Cash

**Call us now**