

4414, TRILLIUM, KENTWOOD, MI, 49512

https://tuckerbenner.com



\$383,400

Be the first to own in Bosgraaf Homes newest community – The Wildflower Condominiums in Kentwood. Close to shopping, GRR Airport, and downtown Grand Rapids these turn-key condominiums are in a perfect location. This 3 bedroom Andover Plan features 1,965 square feet with an open concept main floor living space. The second floor contains 3 [...]

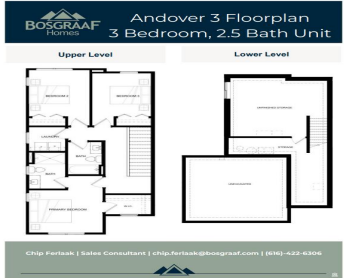

- 3 beds
- 3 baths
- Condominium
- Residential
- Active
- 1965 sq ft



Call us now

Phone: (231)730-8781

Email: tuckerbennerteam@gmail.com

Address: 2747 Lakeshore Drive, Twin Lake, MI 49457

Basics

Category: Residential

Status: Active

Bathrooms: 3 baths

Lot size: 0 sq ft

Subdivision Name: Wildflower Condominiums

Lot Size Acres: 0 acres

County: Kent

Type: Condominium

Bedrooms: 3 beds

Area: 1965 sq ft

Year built: 2025

Bathrooms Full: 2

Rooms Total: 9

Bathrooms Half: 1

Building Details

Building Area Total: 1965 sq ft

Sewer: Public

Stories: 2

Basement: Full

Construction Materials: Stone, Vinyl Siding

Heating: Forced Air

Roof: Shingle

Amenities & Features

Laundry Features: Gas Dryer Hookup, Laundry Room, Upper Level, Washer Hookup

Parking Features: Garage Faces Front, Garage Door Opener, Attached

WaterSource: Public

Interior Features: Garage Door Opener, Center Island

Window Features: Low-Emissivity Windows, Screens

Cooling: Central Air

Flooring: Carpet, Vinyl

Garage Spaces: 2

Appliances: Humidifier, Dishwasher, Disposal, Microwave, Range, Refrigerator

Lot Features: Cul-De-Sac

Patio And Porch Features: Patio

Fees & Taxes

Call us now



Association Fee Frequency:
Monthly

Tax Year: 2024

Association Fee: \$225

Association Fee Includes: Water, Trash, Snow
Removal, Sewer, Lawn/Yard Care

School Information

High School District: Kentwood

Miscellaneous

CrossStreet: 44th and Walma

Listing Terms: Cash, Conventional

Call us now



Phone: (231)730-8781
Email: tuckerbennerteam@gmail.com
Address: 2747 Lakeshore Drive, Twin Lake, MI 49457

