

4477, GILES, ADA, MI, 49301

https://tuckerbenner.com



\$249,000

Beautiful, executive lot community, Terrino, is settled in the heart of quaint Cannon Township. Bring your own builder to this gorgeous parcel nestled between the iconic Honey Creek Inn and Cannonsburg Ski Area. Close to Egypt Valley, Blythefield, and Boulder Creek golf clubs. A short drive gets you to the fantastic downtown Ada area featuring [...]

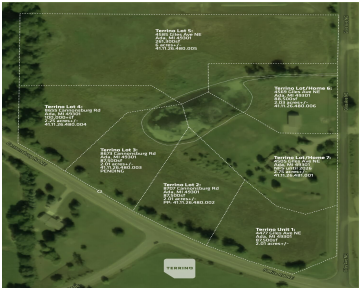

- 0 baths
- Acreage
- Land
- Active



Call us now

Phone: (231)730-8781  
Email: tuckerbennerteam@gmail.com  
Address: 2747 Lakeshore Drive, Twin Lake, MI 49457

# Basics

**Category:** Land  
**Status:** Active  
**Lot size:** 2 sq ft  
**Lot Size Acres:** 2 acres

**Type:** Acreage  
**Bathrooms:** 0 baths  
**Subdivision Name:** Terrino, Lot 1  
**County:** Kent

# Amenities & Features

**Utilities:** Natural Gas Available, Electricity Available, None  
**Lot Features:** Corner Lot

# Fees & Taxes

**Tax Assessed Value:** \$6,727  
**Association Fee:** \$360  
**Tax Annual Amount:** \$216  
**Association Fee Frequency:** Annually  
**Tax Year:** 2024

# School Information

**High School District:** Rockford

# Miscellaneous

**Road Surface Type:** Paved  
**Listing Terms:** Cash, Conventional  
**CrossStreet:** 5 Mile & Cannonsburg

Call us now