

4561, ADA GROVE, ADA, MI, 49301

<https://tuckerbenner.com>

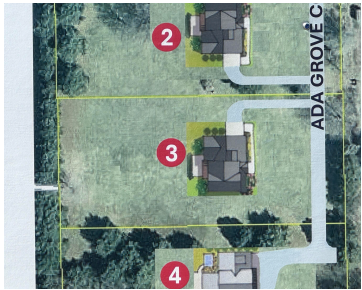

PROPOSED BUILD, listing price reflects pictures, sq ft, and lot price: Welcome to Ada Grove, an exclusive Eastbrook Homes community in Cascade Township that features 1+ acre home sites, tree-lined privacy, and is located within the highly sought-after Forest Hills Central School District. With only three home sites currently available, this intimate setting offers a [...]

- 4 beds
- 3 baths
- Single Family Residence
- Residential
- Active
- 2629 sq ft

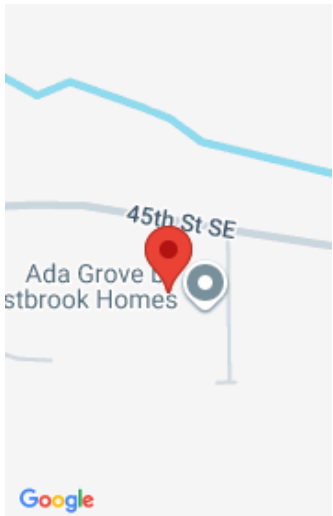

Call us now



Phone: (231)730-8781
Email: tuckerbennerteam@gmail.com
Address: 2747 Lakeshore Drive, Twin Lake, MI 49457



Basics

Category: Residential

Status: Active

Bathrooms: 3 baths

Lot size: 1.12 sq ft

Subdivision Name: Ada Grove

Lot Size Acres: 1.12 acres

County: Kent

Type: Single Family Residence

Bedrooms: 4 beds

Area: 2629 sq ft

Year built: 2026

Bathrooms Full: 3

Rooms Total: 8

Building Details

Building Area Total: 1835 sq ft

Architectural Style: Ranch

Heating: Forced Air

Roof: Composition

Construction Materials: Vinyl Siding

Sewer: Septic Tank

Stories: 1

Basement: Daylight

Amenities & Features

Laundry Features: Laundry Room, Main Level

Parking Features: Attached

WaterSource: Well

Lot Features: Wooded, Cul-De-Sac

Fireplaces Total: 1

Utilities: Natural Gas Available, Electricity Available, Natural Gas Connected

Garage Spaces: 3

Interior Features: Broadband

Window Features: Screens

Cooling: Central Air

School Information

High School District: Forest Hills

HighSchool: Forest Hills Central High School

Call us now



Phone: (231)730-8781

Email: tuckerbennerteam@gmail.com

Address: 2747 Lakeshore Drive, Twin Lake, MI 49457



Miscellaneous

Road Surface Type: Paved

CrossStreet: 45th and Whitneyville

Listing Terms: Cash, Conventional

Call us now



Phone: (231)730-8781

Email: tuckerbennerteam@gmail.com

Address: 2747 Lakeshore Drive, Twin Lake, MI 49457

