

4605, HUNTERS, SIX LAKES, MI, 48886

<https://tuckerbenner.com>

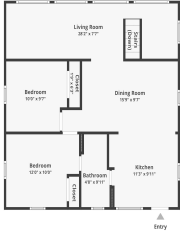

\$260,000



Welcome to your lake cottage on .65 acres. Live here seasonally or year round. Act fast and be in before the end of summer. Many updates have been done in the last couple of years. New Roof(shingles), New Furnace, New Hot Water Heater, Fresh Paint of the Exterior, Updated Bathroom/Shower, Finished non-conforming 3rd bedroom, Finished [...]

- 2 beds
- 1 bath
- Single Family Residence
- Residential
- Active
- 1249 sq ft



Basics



Call us now

Phone: (231)730-8781
 Email: tuckerbennerteam@gmail.com
 Address: 2747 Lakeshore Drive, Twin Lake, MI 49457



Category: Residential

Status: Active

Bathrooms: 1 bath

Lot size: 0.65 sq ft

Bathrooms Full: 1

Rooms Total: 5

Type: Single Family Residence

Bedrooms: 2 beds

Area: 1249 sq ft

Subdivision Name: Indianhead Park

Lot Size Acres: 0.65 acres

County: Montcalm

Building Details

Building Area Total: 784 sq ft

Architectural Style: Cabin/Cottage

Heating: Forced Air

Basement: Walk Out

Construction Materials: Vinyl Siding

Sewer: Septic System

Stories: 1

Amenities & Features

Laundry Features: Electric Dryer Hookup, Gas Dryer Hookup, In Basement, Washer Hookup

Fireplace Features: Family, Wood Burning

Appliances: Range, Refrigerator

Lot Features: Recreational, Wooded

Exterior Features: Scrn Porch, Patio

Cooling: Window Unit(s)

Waterfront Features: Lake

WaterSource: Well

Interior Features: Ceiling Fans, LP Tank Rented

Window Features: Window Treatments

Fireplaces Total: 1

Fees & Taxes

Tax Assessed Value: \$68,880

Tax Annual Amount: \$3,186

Tax Year: 2024



Call us now

Phone: (231)730-8781

Email: tuckerbennerteam@gmail.com

Address: 2747 Lakeshore Drive, Twin Lake, MI 49457



School Information

High School District: Lakeview-Montcalm Co

Miscellaneous

Road Surface Type: Unimproved **CrossStreet:** W Waterwheel Rd & N Hillman Rd

Listing Terms: Cash, Conventional



Call us now

Phone: (231)730-8781

Email: tuckerbennerteam@gmail.com

Address: 2747 Lakeshore Drive, Twin Lake, MI 49457

