

47388, SALTZ, CANTON, MI, 48187

https://tuckerbenner.com

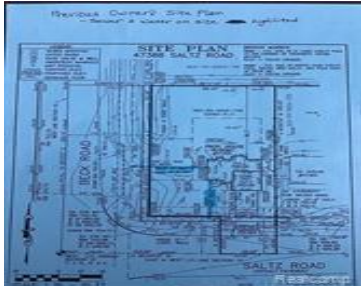

GREAT BUILDABLE LOT IN CANTON WITH PLYMOUTH / CANTON SCHOOLS. SURVEY BY THE PREVIOUS OWNER ATTACHED. SEWER AND WATER AT THE STREET. BUYER TO VERIFY WITH THE TOWNSHIP FOR BUILDING.

- 0 baths
- Lot
- Land
- Active



Basics

Category: Land

Status: Active

Lot size: 0.33 sq ft

County: Wayne

Type: Lot

Bathrooms: 0 baths

Lot Size Acres: 0.33 acres



Call us now

Phone: (231)730-8781
 Email: tuckerbennerteam@gmail.com
 Address: 2747 Lakeshore Drive, Twin Lake, MI 49457



Amenities & Features

Utilities: Water Available, Sewer Available, Natural Gas Available, Water Connected, Sewer Connected, Natural Gas Connected

Lot Features: Buildable, Sidewalk, Corner Lot

Fees & Taxes

Tax Assessed Value: \$20,723

Tax Year: 2023

Tax Annual Amount: \$1,139

Association Fee Includes: None

School Information

High School District: Plymouth-Canton

Miscellaneous

Road Surface Type: Paved

CrossStreet: Saltz and Beck

Listing Terms: Cash, Conventional



Call us now

Phone: (231)730-8781

Email: tuckerbennerteam@gmail.com

Address: 2747 Lakeshore Drive, Twin Lake, MI 49457

