

52386, JOY, DOWAGIAC, MI, 49047

<https://tuckerbenner.com>

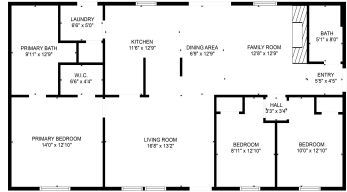

\$200,000



Introducing this charming 3-bedroom, 2-bathroom ranch home nestled on over half an acre of tranquility, with direct easement access to Priest Lake! This beautifully updated residence boasts an open floor plan with vaulted ceilings, brand new flooring and carpet throughout, fresh paint, and newer windows. The spacious fenced-in backyard offers endless possibilities for outdoor fun [...]

- 3 beds
- 2 baths
- Single Family Residence
- Residential
- Active
- 1431 sq ft



Basics



Call us now

Phone: (231)730-8781
 Email: tuckerbennerteam@gmail.com
 Address: 2747 Lakeshore Drive, Twin Lake, MI 49457



Category: Residential

Status: Active

Bathrooms: 2 baths

Lot size: 0.58 sq ft

Bathrooms Full: 2

Rooms Total: 6

Type: Single Family Residence

Bedrooms: 3 beds

Area: 1431 sq ft

Year built: 1994

Lot Size Acres: 0.58 acres

County: Cass

Building Details

Building Area Total: 1431 sq ft

Architectural Style: Ranch

Heating: Forced Air

Basement: Crawl Space

Construction Materials: Vinyl Siding

Sewer: Septic Tank

Stories: 1

Amenities & Features

Laundry Features: Laundry Room

Waterfront Features: Lake

Garage Spaces: 2

Appliances: Washer, Refrigerator, Oven, Dryer

Window Features: Storms, Screens

Fireplaces Total: 1

Parking Features: Garage Door Opener, Detached

Fireplace Features: Other

WaterSource: Well

Lot Features: Level

Exterior Features: Fenced Back, Deck(s)

Cooling: Central Air

Fees & Taxes

Tax Assessed Value: \$44,430

Tax Annual Amount: \$1,436

Tax Year: 2021



Call us now

Phone: (231)730-8781

Email: tuckerbennerteam@gmail.com

Address: 2747 Lakeshore Drive, Twin Lake, MI 49457



School Information

High School District: Dowagiac

Miscellaneous

Road Surface Type: Paved

CrossStreet: Downey St, Topash St

Listing Terms: Cash, FHA, VA Loan, MSHDA, Conventional



Call us now

Phone: (231)730-8781

Email: tuckerbennerteam@gmail.com

Address: 2747 Lakeshore Drive, Twin Lake, MI 49457

