

52451, WASHINGTON, NEW BALTIMORE, MI, 48047

<https://tuckerbenner.com>

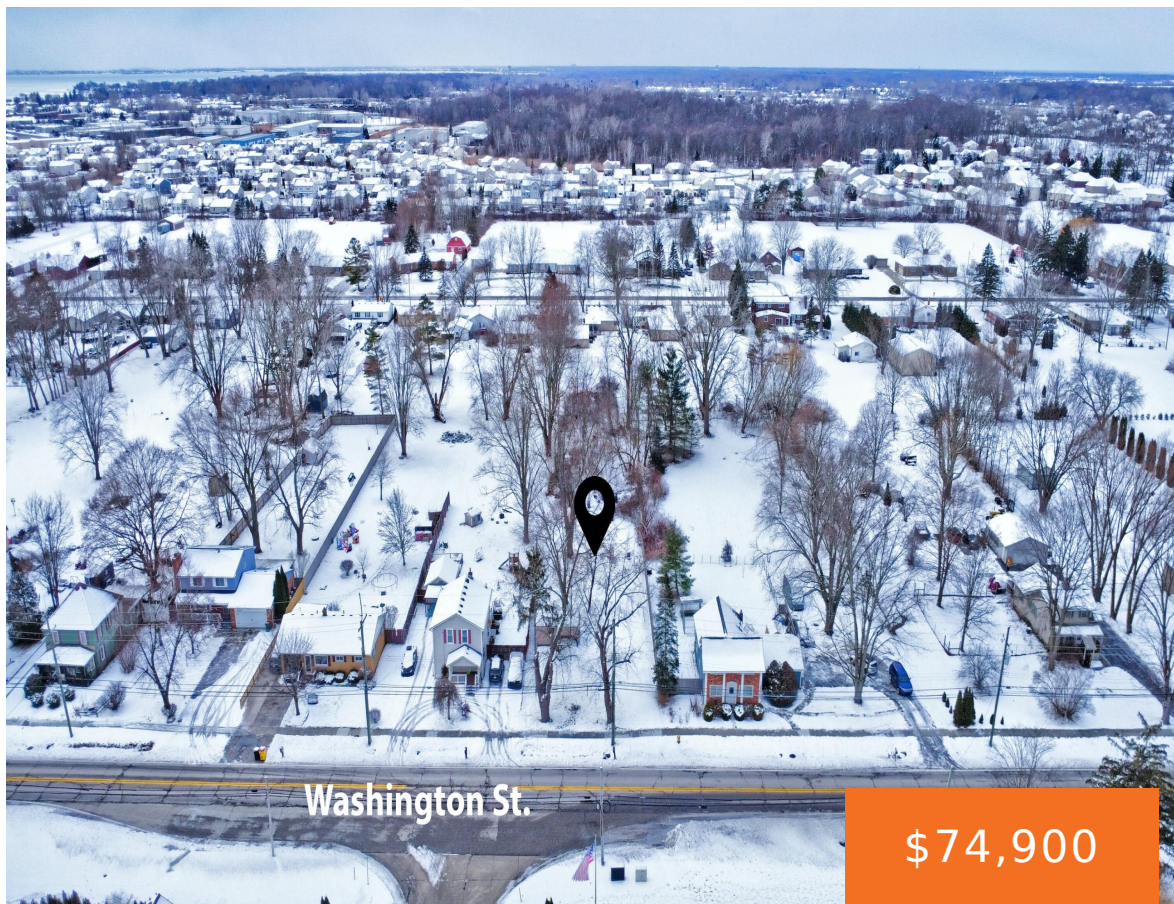

0.50 acres near downtown New Baltimore. Approximately 1 mile to the water! Enjoy a .50 acre lot with 62 feet of road frontage on Washington Street. This is a rare find in the City of New Baltimore. The hard work of clearing the main residence from the lot has been done for you. The small [...]

- 0 baths
- Lot
- Land
- Active

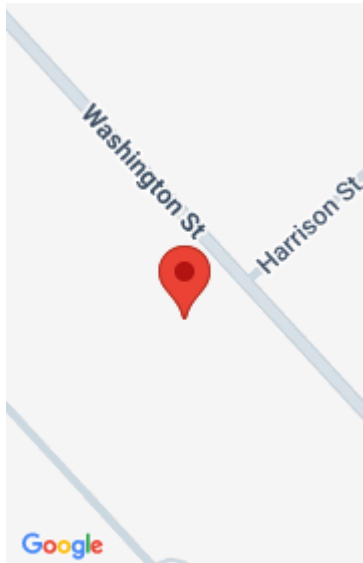

Basics

Category: Land

Status: Active

Lot size: 0.5 sq ft

County: Macomb

Type: Lot

Bathrooms: 0 baths

Lot Size Acres: 0.5 acres

Building Details

Sewer: Public Sewer

Current Use: Residential

Amenities & Features

Utilities: Natural Gas Available, Electricity Available, Natural Gas Connected, Storm Sewer, Electricity Connected

WaterSource: Public

Lot Features: Level, Buildable

Fees & Taxes

Tax Assessed Value: \$52,287

Tax Year: 2025

Tax Annual Amount: \$3,639

School Information

High School District: Anchor Bay

Miscellaneous

Call us now

CrossStreet: Harrison St and Washington St **Listing Terms:** Cash, FHA, VA Loan,
Conventional

Call us now



Phone: (231)730-8781
Email: tuckerbennerteam@gmail.com
Address: 2747 Lakeshore Drive, Twin Lake, MI 49457

