

529, TIMBER, BROOKLYN, MI, 49230

https://tuckerbenner.com

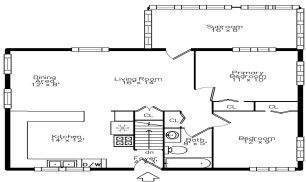

\$349,900



Escape to your own slice of paradise at this beautiful lakefront home on the serene, no-wake Timber Lake, nestled in the picturesque landscape of nearby Lenawee County. From the moment you arrive, a sense of tranquility washes over you. A newly installed sidewalk guides you to the welcoming front deck, a perfect spot to enjoy [...]

- 3 beds
- 2 baths
- Single Family Residence
- Residential
- Active
- 930 sq ft

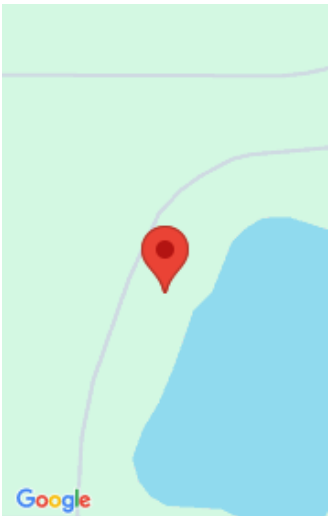

Call us now

Phone: (231)730-8781
Email: tuckerbennerteam@gmail.com
Address: 2747 Lakeshore Drive, Twin Lake, MI 49457



Basics

Category: Residential

Status: Active

Bathrooms: 2 baths

Lot size: 0.36 sq ft

Subdivision Name: Timberlane

Lot Size Acres: 0.36 acres

County: Lenawee

Type: Single Family Residence

Bedrooms: 3 beds

Area: 930 sq ft

Year built: 1970

Bathrooms Full: 1

Rooms Total: 5

Bathrooms Half: 1

Building Details

Building Area Total: 930 sq ft

Architectural Style: Ranch

Heating: Forced Air

Roof: Asphalt

Construction Materials: Vinyl Siding

Sewer: Septic Tank

Stories: 1

Basement: Full, Walk-Out Access

Amenities & Features

Laundry Features: In Basement

Utilities: Phone Available, Electricity Available, Natural Gas Connected, Cable Connected, High-Speed Internet

WaterSource: Well

Interior Features: Ceiling Fan(s), Eat-in Kitchen

Window Features: Replacement

Cooling: Central Air

Flooring: Carpet, Vinyl

Waterfront Features: Lake

Appliances: Dishwasher, Disposal, Dryer, Oven, Range, Refrigerator, Washer, Water Softener Owned

Lot Features: Rolling Hills

Patio And Porch Features: 3 Season Room, Covered, Deck, Enclosed, Screened

Call us now



Fees & Taxes

Tax Assessed Value: \$93,450
Association Fee: \$500
Tax Annual Amount: \$2,613

Association Fee Frequency: Annually
Tax Year: 2024
Association Fee Includes: None

School Information

High School District: Columbia
Middle Or Junior School: Columbia Upper Elementary School

HighSchool: Columbia Central High School
Elementary School: Columbia Elementary School

Miscellaneous

Road Surface Type: Paved
Listing Terms: Cash, FHA, VA Loan, Conventional

CrossStreet: Hess Drive

Call us now