

5339, HARBORVIEW PASS, KALAMAZOO, MI, 49009

<https://tuckerbenner.com>

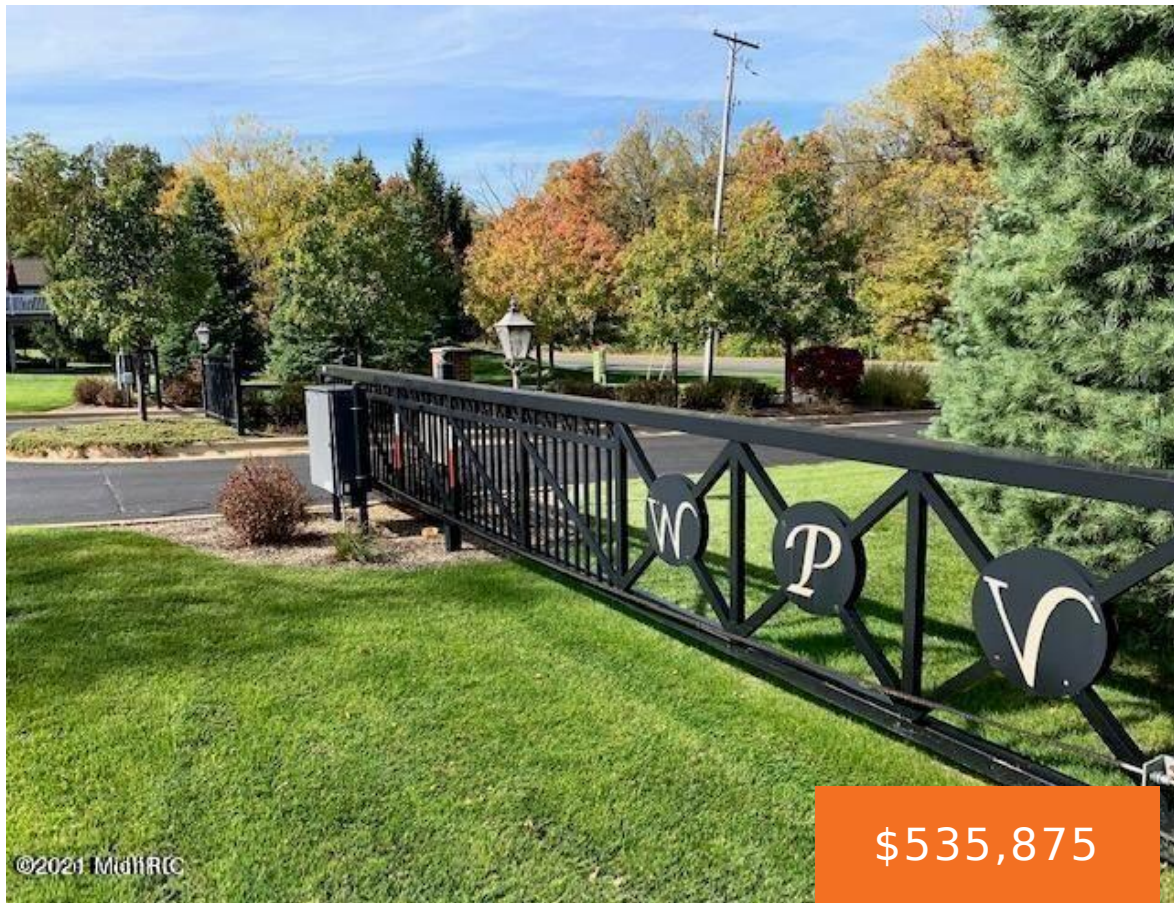

\$535,875



The Chateau at West Port Village, designed and built by Visser Living in desirable Oshtemo Township, Michigan is a new construction condominium offering low-maintenance living, modern finishes, and a prime location near Kalamazoo, major highways, local universities, and the Kal-Haven Trail. Step onto the inviting front porch and into a bright, open-concept floor plan filled [...]

- 2 beds
- 2 baths
- Condominium
- Residential
- Active
- 1447 sq ft



Basics

Call us now



Phone: (231)730-8781
Email: tuckerbennerteam@gmail.com
Address: 2747 Lakeshore Drive, Twin Lake, MI 49457



Category: Residential

Status: Active

Bathrooms: 2 baths

Lot size: 0.1 sq ft

Subdivision Name: West Port Village

Lot Size Acres: 0.1 acres

County: Kalamazoo

Type: Condominium

Bedrooms: 2 beds

Area: 1447 sq ft

Year built: 2026

Bathrooms Full: 2

Rooms Total: 8

Building Details

Building Area Total: 1447 sq ft **Construction Materials:** Stone, Vinyl Siding

Architectural Style: Ranch **Sewer:** Public

Heating: Forced Air **Stories:** 1

Roof: Composition **Basement:** Full

Amenities & Features

Laundry Features: Main Level

Parking Features: Garage Door Opener, Attached

WaterSource: Public

Interior Features: Garage Door Opener, Center Island, Eat-in Kitchen, Pantry

Window Features: Low-Emissivity Windows, Insulated Windows

Cooling: Central Air

Association Amenities: Pets Allowed, Trail(s), Other

Garage Spaces: 2

Appliances: Dishwasher, Microwave, Range, Refrigerator

Lot Features: Level, Sidewalk, Site Condo

Patio And Porch Features: Deck, Porch(es)

Fees & Taxes

Call us now

Phone: (231)730-8781

Email: tuckerbennerteam@gmail.com

Address: 2747 Lakeshore Drive, Twin Lake, MI 49457



Tax Assessed Value: \$646 **Association Fee Frequency:** Monthly

Association Fee: \$275 **Tax Year:** 2025

Tax Annual Amount: \$40 **Association Fee Includes:** Other, Trash, Snow Removal,
Lawn/Yard Care

School Information

High School District: Kalamazoo

Miscellaneous

Road Surface Type: Paved

CrossStreet: Piers End Lane & End

Listing Terms: Cash, Conventional

Call us now



Phone: (231)730-8781

Email: tuckerbennerteam@gmail.com

Address: 2747 Lakeshore Drive, Twin Lake, MI 49457

