

5586, PAW PAW LAKE, COLOMA, MI, 49038  
https://tuckerbenner.com

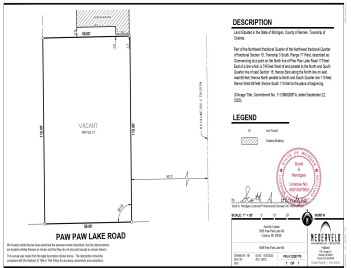

Back on the Market due to Buyer Financing falling through. Lot is surveyed and ready to be built on! Vacant Lot, Steps from Paw Paw Lake. Take a look at this cleared home site ready for all your plans and ideas. Perfect for a Barndominium, Cottage, or Investment Property. Paw Paw Lake is a 900 [...]

- 0 baths
- Lot
- Land
- Active



Call us now

# Basics

**Category:** Land

**Status:** Active

**Lot size:** 0.17 sq ft

**County:** Berrien

**Type:** Lot

**Bathrooms:** 0 baths

**Lot Size Acres:** 0.17 acres

# Building Details

**Sewer:** Public Sewer

**Current Use:** Residential

# Amenities & Features

**Utilities:** Natural Gas Available, Electricity Available, Cable Available, Phone Available, None

**WaterSource:** Well

**Lot Features:** Level, Buildable, Cleared

# Fees & Taxes

**Tax Assessed Value:** \$9,201

**Tax Year:** 2025

**Tax Annual Amount:** \$550

# School Information

**High School District:** Coloma

# Miscellaneous

Call us now

**Road Surface Type:** Paved

**CrossStreet:** Lake Ave & Lakewood Dr.

**Listing Terms:** Cash, Conventional

**Call us now**



Phone: (231)730-8781  
Email: tuckerbennerteam@gmail.com  
Address: 2747 Lakeshore Drive, Twin Lake, MI 49457

