

5690, TRAIL SIDE, HAMBURG, MI, 48189

<https://tuckerbenner.com>

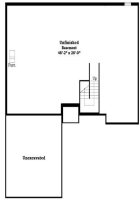

First Floor



Unfinished Basement

\$439,999

New Construction ranch!! Enjoy maintenance-free living in a peaceful setting with mature trees, walking paths, and 183 Acres of preserved wetlands. Located off Strawberry Lake Rd in Hamburg township, you are close to great shopping and dining. The condo features two bedrooms, two full baths, and an open kitchen, dining, and great room. A screened-in [...]

- 2 beds
- 2 baths
- Condominium
- Residential
- Active
- 1523 sq ft

Basics



Call us now

Phone: (231)730-8781
 Email: tuckerbennerteam@gmail.com
 Address: 2747 Lakeshore Drive, Twin Lake, MI 49457



Category: Residential

Status: Active

Bathrooms: 2 baths

Lot size: 0 sq ft

Subdivision Name: Mystic Ridge

Lot Size Acres: 0 acres

Type: Condominium

Bedrooms: 2 beds

Area: 1523 sq ft

Year built: 2023

Bathrooms Full: 2

County: Livingston

Building Details

Construction Materials: Vinyl Siding, Stone

Sewer: Public Sewer

Stories: 1

Architectural Style: Ranch

Heating: Forced Air, Natural Gas

Basement: Full

Amenities & Features

Laundry Features: Main Level

Association Amenities: Walking Trails

Fireplace Features: Gas Log

WaterSource: Well, Public

Interior Features: Ceramic Floor, Garage Door Opener, Eat-in Kitchen

Fireplaces Total: 1

Utilities: Cable Connected

Parking Features: Attached

Garage Spaces: 2

Appliances: Disposal, Microwave

Exterior Features: Porch(es)

Cooling: Central Air

Fees & Taxes

Tax Assessed Value: \$25,000 **Association Fee Frequency:** Monthly

Association Fee: \$210

Tax Year: 2022

Tax Annual Amount: \$517

Association Fee Includes: Snow Removal, Lawn/Yard Care

School Information



Call us now

Phone: (231)730-8781

Email: tuckerbennerteam@gmail.com

Address: 2747 Lakeshore Drive, Twin Lake, MI 49457



High School District: Dexter

Miscellaneous

Listing Terms: Cash, Conventional



Call us now

Phone: (231)730-8781

Email: tuckerbennerteam@gmail.com

Address: 2747 Lakeshore Drive, Twin Lake, MI 49457

