

5744, HEMLOCK, WYOMING, MI, 49418

<https://tuckerbenner.com>

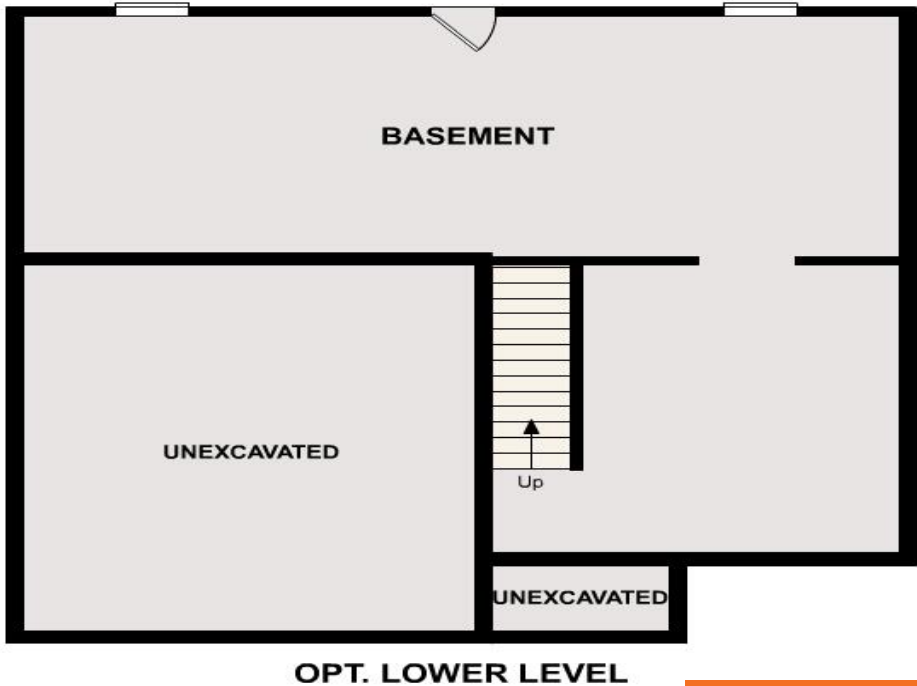

\$413,990

Come check out this beautiful NEW 2-Story Home in the The Reserve at Rivertown Community! The desirable Essex Plan boasts an open design throughout the Living, Dining, and Kitchen. The Kitchen features gorgeous cabinets, quartz countertops, and Stainless-Steel Steel Appliances (Including Range with a Microwave hood and Dishwasher). On the 1st floor, there is a [...]

- 4 beds
- 3 baths
- Single Family Residence
- Residential
- Active
- 2014 sq ft



Basics

Call us now

Phone: (231)730-8781
 Email: tuckerbennerteam@gmail.com
 Address: 2747 Lakeshore Drive, Twin Lake, MI 49457



Category: Residential

Status: Active

Bathrooms: 3 baths

Lot size: 0.22 sq ft

Subdivision Name: The Reserve at Rivertown

Lot Size Acres: 0.22 acres

County: Kent

Type: Single Family Residence

Bedrooms: 4 beds

Area: 2014 sq ft

Year built: 2026

Bathrooms Full: 2

Rooms Total: 9

Bathrooms Half: 1

Building Details

Building Area Total: 2820 sq ft

Architectural Style: Traditional

Heating: Forced Air

Roof: Shingle

Construction Materials: Vinyl Siding

Sewer: Public

Stories: 2

Basement: Daylight

Amenities & Features

Laundry Features: Electric Dryer Hookup, Laundry Room, Washer Hookup

Garage Spaces: 2

Appliances: Dishwasher, Microwave, Range

Cooling: Central Air

Parking Features: Garage Door Opener, Attached

WaterSource: Public

Window Features: Low-Emissivity Windows

Fees & Taxes

Tax Assessed Value: \$945

Association Fee: \$85

Tax Annual Amount: \$300

Association Fee Frequency: Annually

Tax Year: 2025

Association Fee Includes: Other

Call us now



Phone: (231)730-8781

Email: tuckerbennerteam@gmail.com

Address: 2747 Lakeshore Drive, Twin Lake, MI 49457



School Information

High School District: Grandville

Miscellaneous

CrossStreet: red cedar dr sw

Listing Terms: Cash, FHA, VA Loan, Conventional

Call us now



Phone: (231)730-8781

Email: tuckerbennerteam@gmail.com

Address: 2747 Lakeshore Drive, Twin Lake, MI 49457

