

6, LILAC, GRAND BEACH, MI, 49117

https://tuckerbenner.com

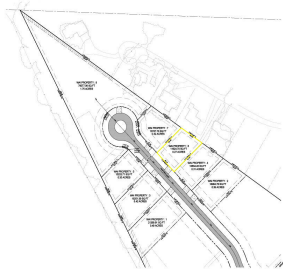

- 0 baths
- Lot
- Land
- Active

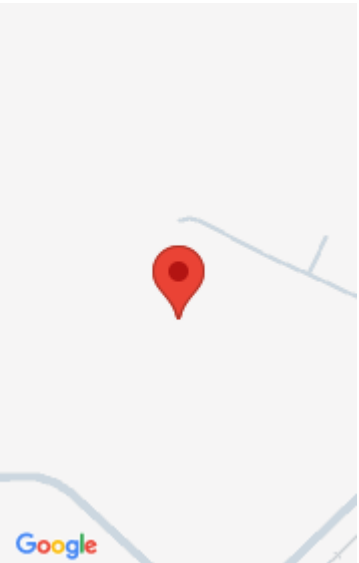

Call us now

Phone: (231)730-8781  
Email: tuckerbennerteam@gmail.com  
Address: 2747 Lakeshore Drive, Twin Lake, MI 49457



# Basics

**Category:** Land

**Status:** Active

**Lot size:** 0.27 sq ft

**Lot Size Acres:** 0.27 acres

**Type:** Lot

**Bathrooms:** 0 baths

**Subdivision Name:** Haven

**County:** Berrien

# Building Details

**Sewer:** Septic Tank

**Current Use:** Residential

# Amenities & Features

**Utilities:** Natural Gas Available, Electricity Available, None

**WaterSource:** Public

**Waterfront Features:** Lake

**Lot Features:** Level, Site Condo, Buildable, Golf Community

# Fees & Taxes

**Tax Assessed Value:** \$576,776

**Tax Year:** 2025

**Tax Annual Amount:** \$1

**Association Fee Includes:** Snow Removal, Other

# School Information

**High School District:** New Buffalo

# Miscellaneous

Call us now

**Road Surface Type:** Paved

**CrossStreet:** Grand Beach Road

**Listing Terms:** Cash, Conventional

**Call us now**



Phone: (231)730-8781  
Email: tuckerbennerteam@gmail.com  
Address: 2747 Lakeshore Drive, Twin Lake, MI 49457

