

610, 5TH, ANN ARBOR, MI, 48104

<https://tuckerbenner.com>

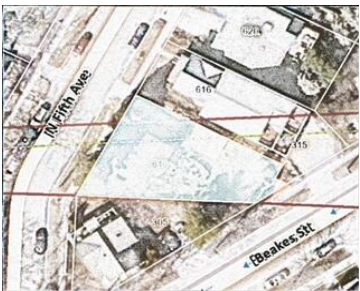

Prime Ann Arbor location in the heart of Kerrytown/Downtown. Zoned R4C – perfect for condos, apartments, or a single custom luxury home. Near train station, hospitals and UM Medical, Main & North campuses, BTB Trail, Farmer’s Market, new DTE & River District developments. The lot fronts both Fifth Ave. & Beakes St. and is approximately [...]

- 3 beds
- 2 baths
- Single Family Residence
- Residential
- Active
- 1430 sq ft



Basics

Call us now

Category: Residential

Status: Active

Bathrooms: 2 baths

Lot size: 0.11 sq ft

Bathrooms Full: 2

Rooms Total: 6

Type: Single Family Residence

Bedrooms: 3 beds

Area: 1430 sq ft

Year built: 1910

Lot Size Acres: 0.11 acres

County: Washtenaw

Building Details

Building Area Total: 910 sq ft

Architectural Style: Traditional

Heating: Forced Air

Basement: Full, Walk-Out Access

Construction Materials: Aluminum Siding, Brick

Sewer: Public Sewer

Stories: 3

Amenities & Features

Laundry Features: In Basement

Garage Spaces: 1

Parking Features: Garage Faces Front, Detached

WaterSource: Public

Fees & Taxes

Tax Assessed Value: \$137,445

Tax Annual Amount: \$7,269

Tax Year: 2024

School Information

High School District: Ann Arbor

Middle Or Junior School: Forsythe or Slauson

HighSchool: Skyline

Elementary School: Bach

Call us now



Phone: (231)730-8781



Email: tuckerbennerteam@gmail.com



Address: 2747 Lakeshore Drive, Twin Lake, MI 49457



Miscellaneous

CrossStreet: Beakes and Summit

Listing Terms: Cash, Conventional

Call us now



Phone: (231)730-8781
Email: tuckerbennerteam@gmail.com
Address: 2747 Lakeshore Drive, Twin Lake, MI 49457

