

61570, RAINTREE, STURGIS, MI, 49091

<https://tuckerbenner.com>

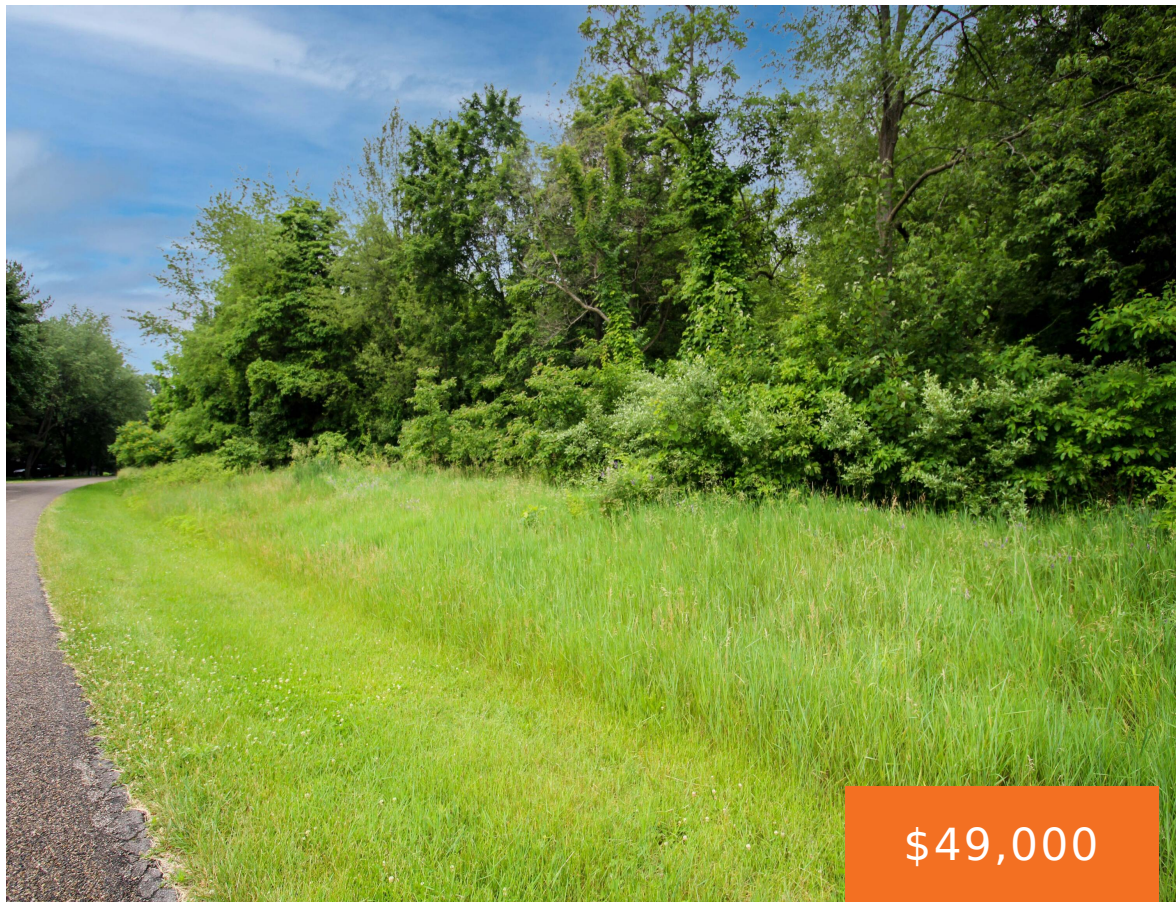

Build your dream home on this fantastic lot with breathtaking views of beautiful Lake Templene. This prime piece of real estate backs up to a prestigious golf course, offering an unparalleled blend of natural beauty and recreational opportunity. Imagine waking up to serene lake views and enjoying a round of golf just a golf cart [...]

- 0 baths
- Lot
- Land
- Active



Basics

Category: Land
Status: Active
Lot size: 0.81 sq ft
County: St. Joseph

Type: Lot
Bathrooms: 0 baths
Lot Size Acres: 0.81 acres

Call us now



Phone: (231)730-8781
Email: tuckerbennerteam@gmail.com
Address: 2747 Lakeshore Drive, Twin Lake, MI 49457



Amenities & Features

Utilities: None **Lot Features:** Level, Golf Community, Wooded

Fees & Taxes

Tax Assessed Value: \$11,575	Association Fee Frequency: Annually
Association Fee: \$315	Tax Year: 2024
Tax Annual Amount: \$490.98	

School Information

High School District: Nottawa

Miscellaneous

Road Surface Type: Paved	CrossStreet: Irongate Dr.
Listing Terms: Cash, Conventional	

Call us now