

62494, CANNONSBURG, BELMONT, MI, 49306

<https://tuckerbenner.com>

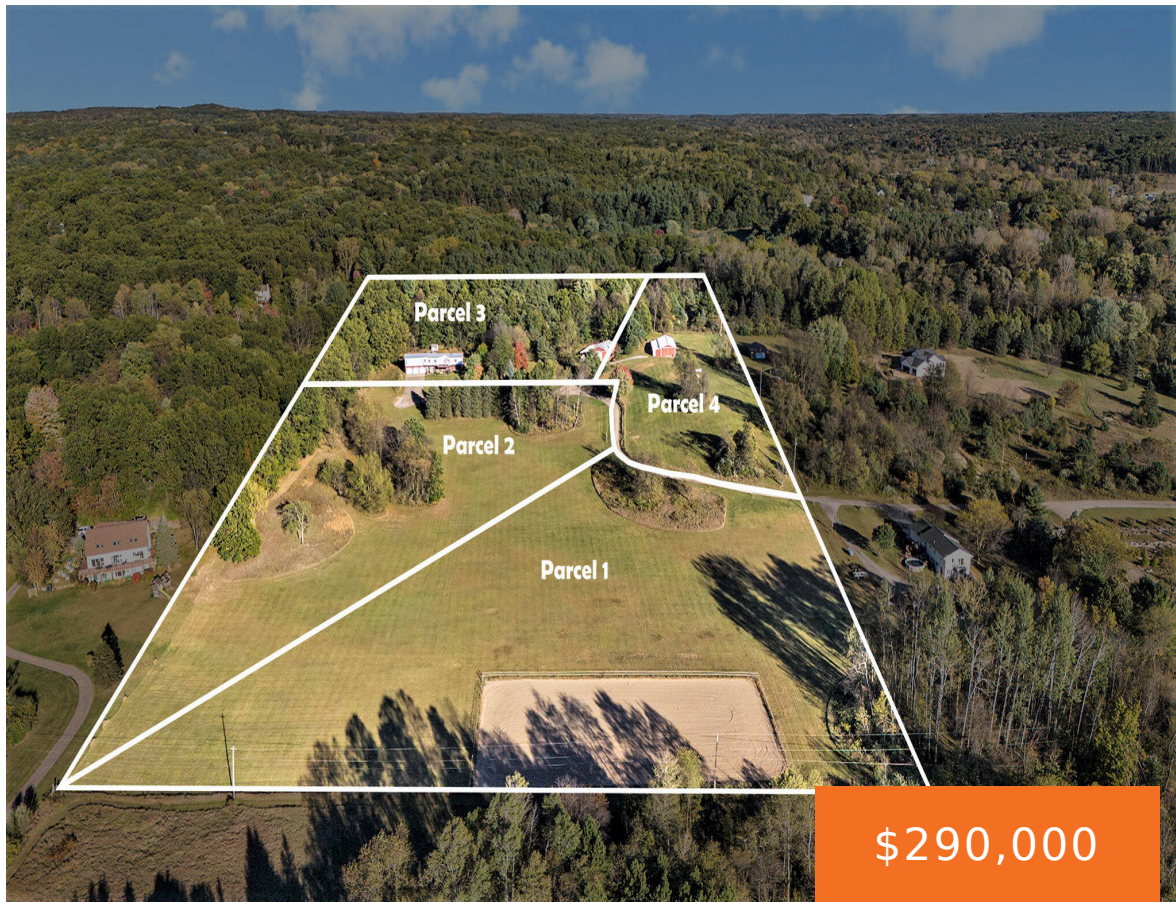

Check out this beautiful homesite. Discover an exclusive chance to reside in the highly sought-after Cannon township. This homesite, boasting a rolling 2.79 acres, with with Pole Barn ideal for those who desire privacy yet close and convenient to travel and shopping. This homesite sets back 1200 ft off Cannonsburg Rd on a dedicated private [...]

- 0 baths
- Acreage
- Land
- Active

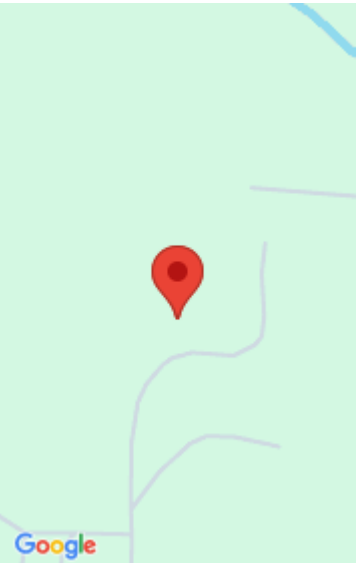

Call us now

Phone: (231)730-8781
Email: tuckerbennerteam@gmail.com
Address: 2747 Lakeshore Drive, Twin Lake, MI 49457



Basics

Category: Land

Status: Active

Lot size: 2.79 sq ft

County: Kent

Type: Acreage

Bathrooms: 0 baths

Lot Size Acres: 2.79 acres

Amenities & Features

Utilities: Natural Gas Available, Cable Available, Electricity Connected

Lot Features: Rolling Hills, Buildable

Fees & Taxes

Tax Assessed Value: \$1

Tax Year: 2024

Tax Annual Amount: \$3,900

School Information

High School District: Rockford

Miscellaneous

CrossStreet: Egypt Valley

Listing Terms: Cash, Conventional

Call us now