

6359, KILKENNY, CANADIAN LAKES, MI, 49346

https://tuckerbenner.com

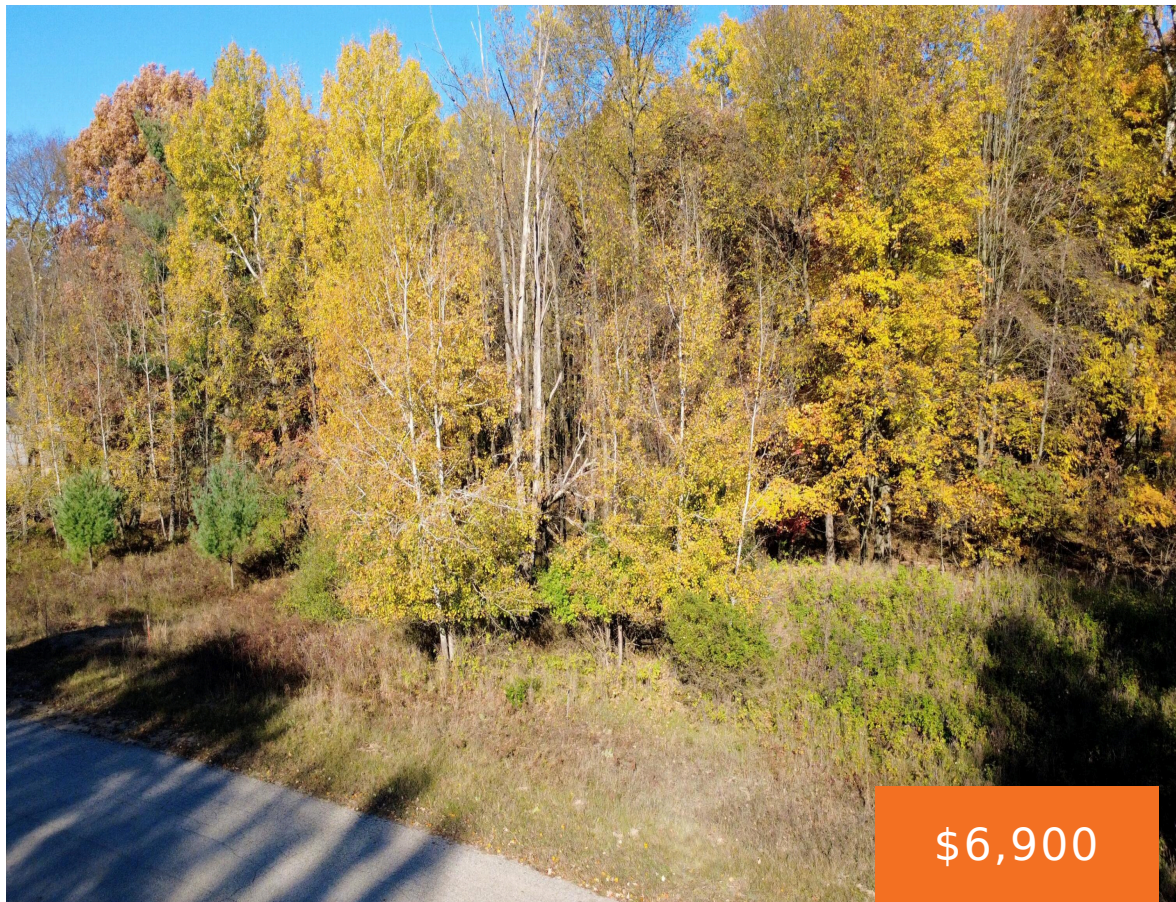

Buildable Lot in the Heart of Canadian Lakes! Discover the perfect spot to build your dream home in the sought-after Canadian Lakes community. This beautiful, partially wooded lot sits on a paved road and is ready for your builder—just bring your plans and start living the good life! As a property owner, you’ll enjoy access [...]

- 0 baths
- Acreage
- Land
- Active

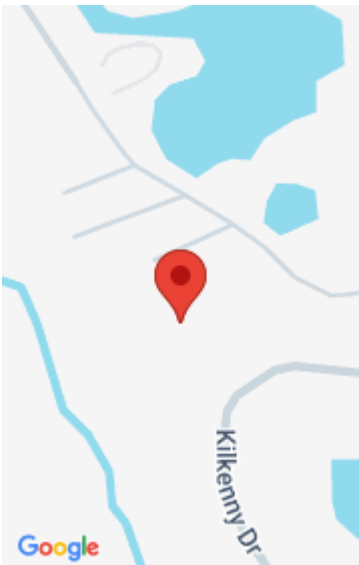

Call us now



Phone: (231)730-8781
Email: tuckerbennerteam@gmail.com
Address: 2747 Lakeshore Drive, Twin Lake, MI 49457



Basics

Category: Land

Status: Active

Lot size: 1.45 sq ft

County: Mecosta

Type: Acreage

Bathrooms: 0 baths

Lot Size Acres: 1.45 acres

Building Details

Current Use: Residential

Amenities & Features

Utilities: Natural Gas Available, Electricity Available, None

Association Amenities: Airport Landing Strip, Baseball Diamond, Beach Area, Campground, Fitness Center, Golf Membership, Indoor Pool, Library, Meeting Room, Restaurant/Bar, Security, Skiing, Spa/Hot Tub, Storage, Tennis Court(s), Boat Launch, Other, Clubhouse, Pool, Sauna, Trail(s)

Waterfront Features: Lake, River

Lot Features: Level, Buildable, Recreational, Wooded

Fees & Taxes

Tax Assessed Value: \$4,200

Association Fee: \$870

Tax Annual Amount: \$1,680

Association Fee Frequency: Annually

Tax Year: 2025

Association Fee Includes: Snow Removal

School Information

High School District: Chippewa Hills

Call us now

Miscellaneous

Road Surface Type: Paved **CrossStreet:** Pierce Road to 110th Avenue
Listing Terms: Cash, Conventional

Call us now



Phone: (231)730-8781
Email: tuckerbennerteam@gmail.com
Address: 2747 Lakeshore Drive, Twin Lake, MI 49457

