

6530, EARL JUNE, DEXTER, MI, 48130

<https://tuckerbenner.com>

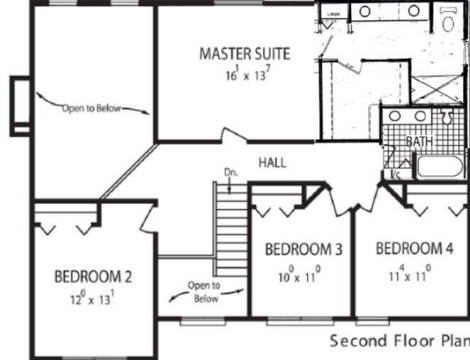

\$548,400

To be built. The Newberry is a thoughtfully designed floorplan with a 2 story light filled great room. Large kitchen with quartz countertops and engineered hardwood floors. Main floor study and additional flex room add to possibilities for a secondary home office, play room, elegant dining space or extra space to just relax. This 4 [...]

- 4 beds
- 2 baths
- Single Family Residence
- Residential
- Active
- 2400 sq ft



Basics

Call us now

Phone: (231)730-8781
Email: tuckerbennerteam@gmail.com
Address: 2747 Lakeshore Drive, Twin Lake, MI 49457



Category: Residential

Status: Active

Bathrooms: 2 baths

Lot size: 0.38 sq ft

Subdivision Name: Hillside Acres

Lot Size Acres: 0.38 acres

County: Washtenaw

Type: Single Family Residence

Bedrooms: 4 beds

Area: 2400 sq ft

Year built: 2026

Bathrooms Full: 1

Rooms Total: 2400

Bathrooms Half: 1

Building Details

Building Area Total: 2400 sq ft

Architectural Style: Colonial

Stories: 2

Basement: Full

Construction Materials: Brick, Vinyl Siding

Heating: Forced Air

Roof: Shingle

Amenities & Features

Laundry Features: Laundry Room, Main Level

Garage Spaces: 3

Lot Features: Cul-De-Sac

Parking Features: Garage Faces Front, Attached

WaterSource: Well

Cooling: Central Air

Fees & Taxes

Tax Year: 2025

Association Fee Includes: None

School Information

High School District: Dexter

Call us now



Phone: (231)730-8781

Email: tuckerbennerteam@gmail.com

Address: 2747 Lakeshore Drive, Twin Lake, MI 49457



Miscellaneous

CrossStreet: N. Territorial, Dexter-townhal

Listing Terms: Cash, FHA, VA Loan, Rural Development, Conventional

Call us now



Phone: (231)730-8781

Email: tuckerbennerteam@gmail.com

Address: 2747 Lakeshore Drive, Twin Lake, MI 49457

