

657, MADEIRA, TRAVERSE CITY, MI, 49696

https://tuckerbenner.com

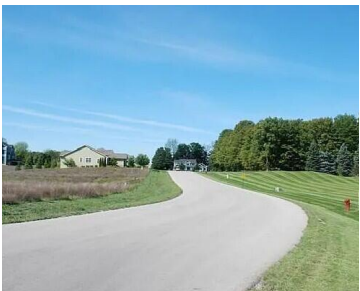

Bring your builder! Outstanding opportunity to build in Verndale at EastBay on an interior homesite. Large homesite allows for 3 car side entry garage on a private site with a south eastern exposure for morning sunrises. 7 other homesites available for a bulk transaction. See HOA docs for building restrictions.

- 0 baths
- Lot
- Land
- Active

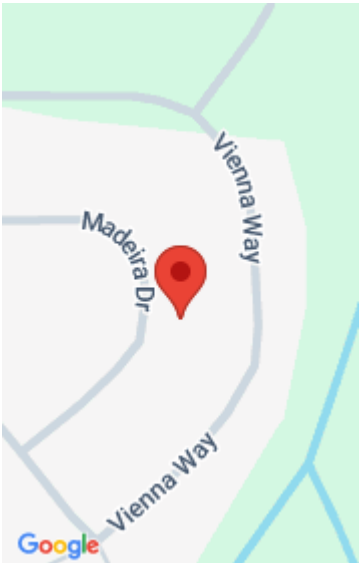

Basics

Category: Land

Status: Active

Lot size: 0.38 sq ft

Lot Size Acres: 0.38 acres

Type: Lot

Bathrooms: 0 baths

Subdivision Name: Verndale at EastBay

County: Grand Traverse County

Building Details

Sewer: Public Sewer

Current Use: Residential

Amenities & Features

Utilities: Natural Gas Available, Electricity Available, Cable Available, Phone Connected, Natural Gas Connected, Phone Available, Storm Sewer, Electricity Connected

WaterSource: Public

Lot Features: Site Condo, Buildable, Cleared

Fees & Taxes

Tax Assessed Value: \$15,362

Association Fee: \$400

Tax Annual Amount: \$400

Association Fee Frequency: Annually

Tax Year: 2024

Association Fee Includes: None

School Information

High School District: Traverse City

Call us now

Miscellaneous

Road Surface Type: Paved

CrossStreet: Hammond and
Three Mile Rd

Listing Terms: Cash, FHA, MSHDA, Rural Development, VA
Loan, 2nd Mortgage, Build to Suit, Conventional

Call us now



Phone: (231)730-8781
Email: tuckerbennerteam@gmail.com
Address: 2747 Lakeshore Drive, Twin Lake, MI 49457

