

<https://tuckerbenner.com>

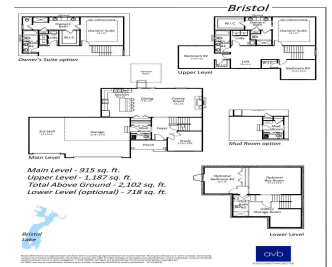

- 4 beds
- 4 baths
- Single Family Residence
- Residential
- Active
- 2821 sq ft



Basics

Category: Residential

Status: Active

Bathrooms: 4 baths

Lot size: 0.7 sq ft

Subdivision Name: Meadowshire

Lot Size Acres: 0.7 acres

County: Kalamazoo

Type: Single Family Residence

Bedrooms: 4 beds

Area: 2821 sq ft

Year built: 2026

Bathrooms Full: 3

Rooms Total: 12

Bathrooms Half: 1

Building Details

Building Area Total: 2102 sq ft

Architectural Style: Traditional

Heating: ENERGY STAR Qualified Equipment, Forced Air

Roof: Asphalt, Composition, Shingle

Construction Materials: Vinyl Siding

Sewer: Septic Tank

Stories: 2

Basement: Full

Amenities & Features

Laundry Features: Gas Dryer Hookup, Laundry Room, Upper Level, Washer Hookup

Utilities: Natural Gas Available, Electricity Available, Cable Available, Natural Gas Connected

Fireplace Features: Family Room, Gas Log

WaterSource: Well

Interior Features: Ceiling Fan(s), Garage Door Opener, Center Island, Eat-in Kitchen, Pantry

Window Features: Low-Emissivity Windows, Screens, Insulated Windows

Fireplaces Total: 1

Flooring: Carpet, Vinyl

Parking Features: Garage Faces Front, Garage Door Opener, Attached

Garage Spaces: 3

Appliances: Humidifier, Dishwasher, Microwave, Range, Refrigerator

Lot Features: Level, Wooded, Site Condo

Patio And Porch Features: Patio, Porch(es)

Cooling: Central Air, SEER 13 or Greater

Call us now



Fees & Taxes

Tax Assessed Value: \$140,426
Tax Annual Amount: \$4,738

Tax Year: 2025

School Information

High School District: Gull Lake	HighSchool: Gull Lake High School
Middle Or Junior School: Gull Lake Middle School	Elementary School: Richland Elementary School

Miscellaneous

Road Surface Type: Paved	CrossStreet: N 28th St. & N Sprinkle Rd.
Listing Terms: Cash, Conventional	

Call us now