

6771, STAPLE, TWIN LAKE, MI, 49457

<https://tuckerbenner.com>

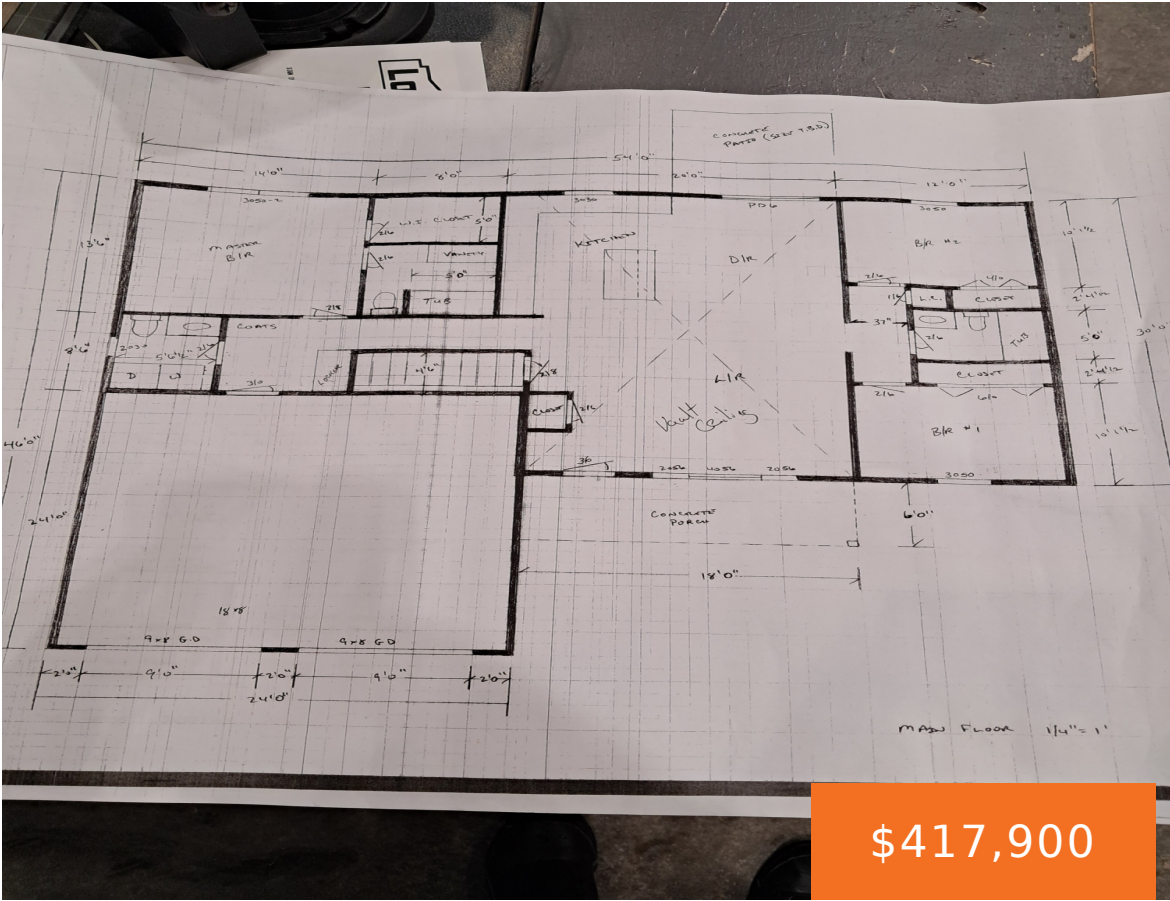

\$417,900

New construction nearly complete offering a modern style ranch design with open floor plan. This beautifully designed home features 1440 finished sq ft of living space with 3 bedrooms and 2.5 bathrooms located on just over an acre. The main floor has vaulted ceilings, a spacious kitchen with quartz countertops, and main floor laundry. The [...]

- 3 beds
- 3 baths
- Single Family Residence
- Residential
- Active
- 1440 sq ft

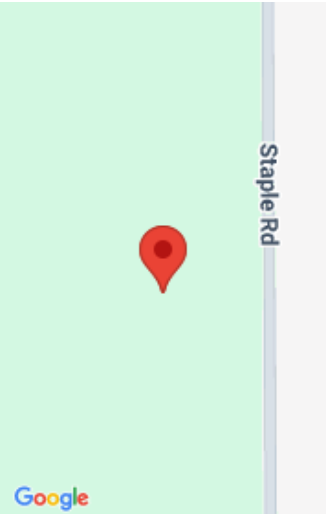

Call us now

Phone: (231)730-8781
Email: tuckerbennerteam@gmail.com
Address: 2747 Lakeshore Drive, Twin Lake, MI 49457



Basics

Category: Residential

Status: Active

Bathrooms: 3 baths

Lot size: 1 sq ft

Bathrooms Full: 2

Rooms Total: 8

Bathrooms Half: 1

Type: Single Family Residence

Bedrooms: 3 beds

Area: 1440 sq ft

Year built: 2026

Lot Size Acres: 1 acres

County: Muskegon

Building Details

Building Area Total: 1440 sq ft

Architectural Style: Ranch

Heating: Forced Air

Roof: Shingle

Construction Materials: Vinyl Siding

Sewer: Septic Tank

Stories: 1

Basement: Full

Amenities & Features

Laundry Features: Laundry Room, Main Level

Utilities: Electricity Available, Natural Gas Connected

Garage Spaces: 2

Interior Features: Garage Door Opener, Center Island

Patio And Porch Features: Patio, Porch(es)

Flooring: Ceramic Tile, Vinyl

Parking Features: Garage Door Opener, Attached

WaterSource: Well

Lot Features: Wooded

Cooling: Central Air

Fees & Taxes

Call us now



Phone: (231)730-8781

Email: tuckerbennerteam@gmail.com

Address: 2747 Lakeshore Drive, Twin Lake, MI 49457



Tax Assessed Value: \$2,025

Tax Year: 2025

Tax Annual Amount: \$308

School Information

High School District: Whitehall

Miscellaneous

Road Surface Type: Paved

CrossStreet: Lakewood and E White Lk

Listing Terms: Cash, FHA, VA Loan, Conventional

Call us now



Phone: (231)730-8781

Email: tuckerbennerteam@gmail.com

Address: 2747 Lakeshore Drive, Twin Lake, MI 49457

