

69704, GARVER LAKE, EDWARDSBURG, MI, 49112

https://tuckerbenner.com

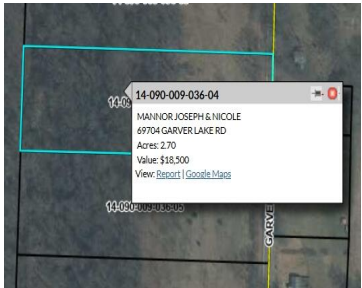

Discover 8.1 beautiful acres located in the desirable Edwardsburg School District. This buildable parcel offers the perfect blend of open ground and mature woods, providing both space and privacy in a peaceful neighborhood setting. West side of property runs along Garver Creek. Enjoy being just minutes from scenic Garver Lake—ideal for outdoor recreation and lake [...]

- 0 baths
- Acreage
- Land
- Active



Basics

Category: Land

Status: Active

Lot size: 8.1 sq ft

County: Cass

Type: Acreage

Bathrooms: 0 baths

Lot Size Acres: 8.1 acres

Call us now



Phone: (231)730-8781

Email: tuckerbennerteam@gmail.com

Address: 2747 Lakeshore Drive, Twin Lake, MI 49457



Building Details

Current Use: Recreational, Hunting, Agricultural

Amenities & Features

Utilities: Electricity Available, Phone Available, None

Association Amenities: Trail(s)

Waterfront Features: Stream/Creek

Lot Features: Level, Buildable, Cleared, Tillable, Wooded

Fees & Taxes

Tax Assessed Value: \$18,500

Tax Year: 2025

Association Fee Includes: None

School Information

High School District: Edwardsburg

Miscellaneous

Road Surface Type: Paved

CrossStreet: May St. & South Ridge Dr.

Listing Terms: Cash, Conventional

Call us now



Phone: (231)730-8781

Email: tuckerbennerteam@gmail.com

Address: 2747 Lakeshore Drive, Twin Lake, MI 49457

