

7003, SANCTUARY, JACKSON, MI, 49201

<https://tuckerbenner.com>

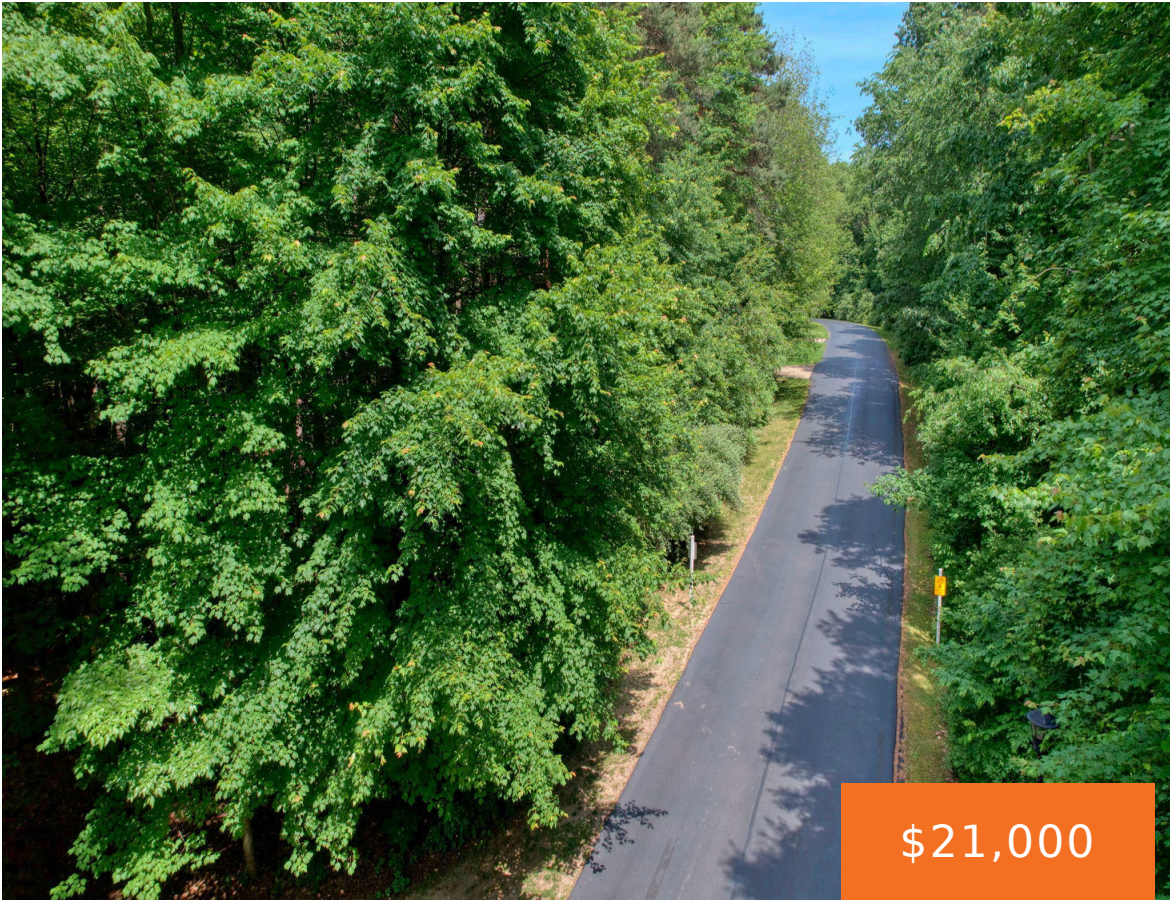

Discover your own slice of serenity in Brills Lake Sanctuary! This beautiful, wooded 1-acre lot offers the ideal setting to design and build your dream home. Nestled within a private, gated community, you'll enjoy deeded access to Brills Lake—a peaceful, 150-acre all-sports lake perfect for pontooning, kayaking, and soaking in nature. Located just 10 minutes [...]

- 0 baths
- Lot
- Land
- Active



Basics

Category: Land

Status: Active

Lot size: 1.02 sq ft

Lot Size Acres: 1.02 acres

Type: Lot

Bathrooms: 0 baths

Subdivision Name: Sanctuary at Brills Lake

County: Jackson

Call us now



Phone: (231)730-8781

Email: tuckerbennerteam@gmail.com

Address: 2747 Lakeshore Drive, Twin Lake, MI 49457



Building Details

Sewer: Public Sewer

Current Use: Residential

Amenities & Features

Utilities: Natural Gas Available, Electricity Available, None

Association Amenities: Security

Waterfront Features: Lake

Lot Features: Rolling Hills, Buildable, Wooded

Fees & Taxes

Tax Assessed Value: \$7,173

Association Fee Frequency: Annually

Association Fee: \$500

Tax Year: 2025

Tax Annual Amount: \$301

Association Fee Includes: Snow Removal, Other

School Information

High School District: East Jackson

Miscellaneous

Road Surface Type: Paved

CrossStreet: Off Whipple

Listing Terms: Cash, Conventional

Call us now



Phone: (231)730-8781

Email: tuckerbennerteam@gmail.com

Address: 2747 Lakeshore Drive, Twin Lake, MI 49457

