

7009, GLENN OAKS, SOUTH HAVEN, MI, 49090

<https://tuckerbenner.com>

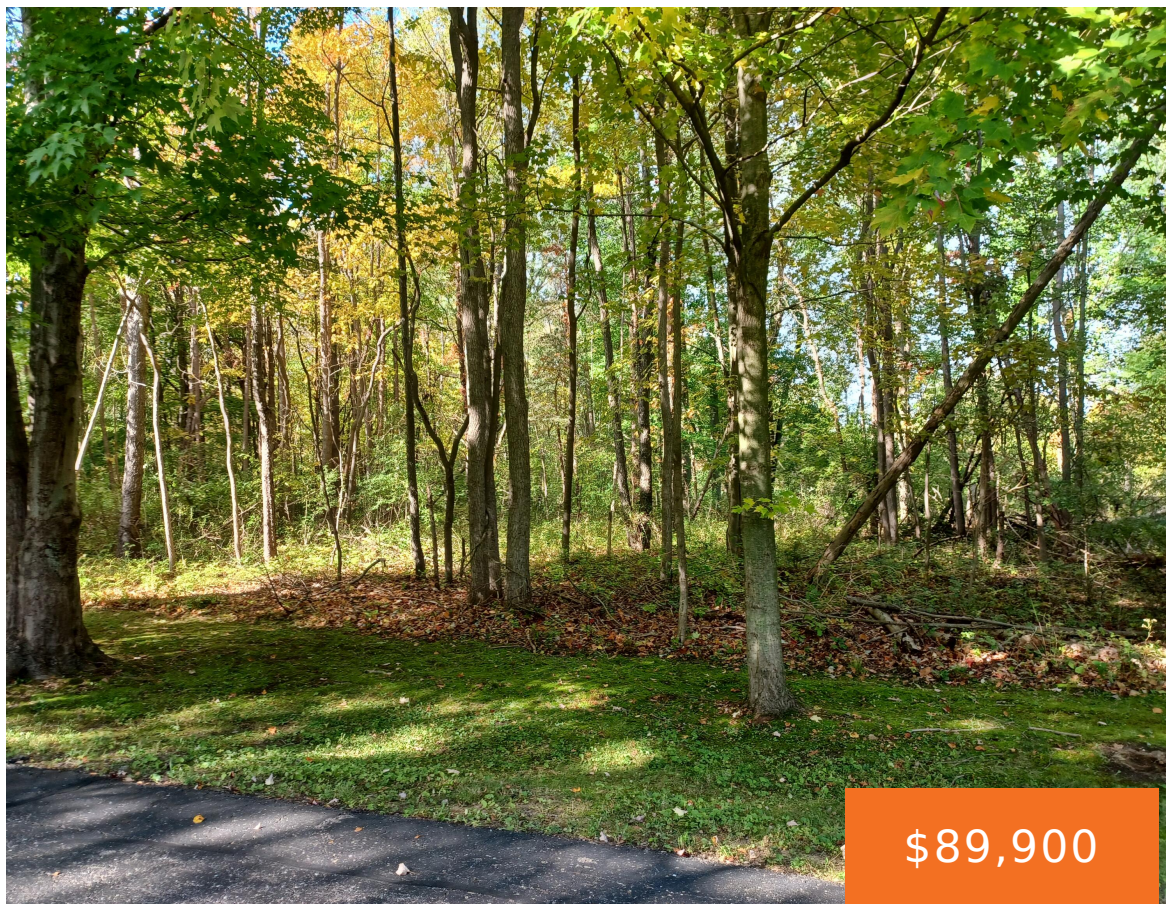

\$89,900

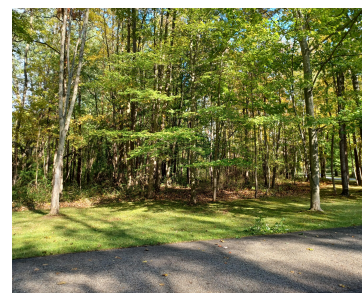
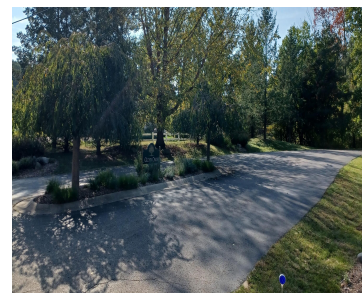

BEAUTIFUL WOODED PARCEL 3 BLOCKS FROM LAKE MICHIGAN. THIS PICTURESQUE PROPERTY IS WAITING FOR YOU TO BUILD YOUR DREAM HOME. SCENIC POND FOR PICNICS AND ENTERTAINING. THIS ACREAGE IS PERFECTLY LOCATED BETWEEN SAUGATUCK AND SOUTH HAVEN.

- 0 baths
- Acreage
- Land
- Active



Basics

Category: Land

Status: Active

Lot size: 1.65 sq ft

Lot Size Acres: 1.65 acres

Type: Acreage

Bathrooms: 0 baths

Subdivision Name: Glenn Oaks

County: Allegan



Call us now

Phone: (231)730-8781

Email: tuckerbennerteam@gmail.com

Address: 2747 Lakeshore Drive, Twin Lake, MI 49457



Amenities & Features

Utilities: Electricity Available, Electricity Connected

Lot Features: Wooded

Fees & Taxes

Tax Assessed Value: \$46,000

Tax Year: 2024

Tax Annual Amount: \$1,000

School Information

High School District: Glenn

Miscellaneous

CrossStreet: 114th & 111th

Listing Terms: Cash, FHA, Conventional, Contract



Call us now

Phone: (231)730-8781

Email: tuckerbennerteam@gmail.com

Address: 2747 Lakeshore Drive, Twin Lake, MI 49457

