

7206, 10TH, REMUS, MI, 49340

<https://tuckerbenner.com>

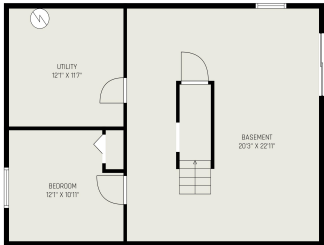

Professional photos to be added 9/13 Private and scenic setting for this country estate. 4 bed 3 bath walk-out home is perfectly located on 10 acres hosting two additional out buildings and rolling elevations add to the tranquility. This home has great structure and layout, a little paint and new carpet can modernize this home [...]

- 4 beds
- 3 baths
- Single Family Residence
- Residential
- Active
- 2500 sq ft

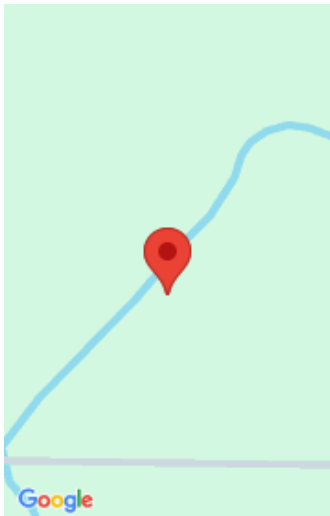

Call us now

Phone: (231)730-8781

Email: tuckerbennerteam@gmail.com

Address: 2747 Lakeshore Drive, Twin Lake, MI 49457

Basics

Category: Residential

Status: Active

Bathrooms: 3 baths

Lot size: 9.93 sq ft

Bathrooms Full: 2

Rooms Total: 4

Bathrooms Half: 1

Type: Single Family Residence

Bedrooms: 4 beds

Area: 2500 sq ft

Year built: 1972

Lot Size Acres: 9.93 acres

County: Mecosta

Building Details

Building Area Total: 1800 sq ft

Architectural Style: Traditional

Heating: Baseboard

Roof: Metal

Construction Materials: Vinyl Siding

Sewer: Septic Tank

Stories: 2

Basement: Walk-Out Access

Amenities & Features

Laundry Features: Main Level

Garage Spaces: 2

Lot Features: Wooded

Parking Features: Detached, Attached

WaterSource: Well

Fireplaces Total: 1

Fees & Taxes

Tax Assessed Value: \$109,198

Tax Year: 2024

School Information

Call us now



Phone: (231)730-8781

Email: tuckerbennerteam@gmail.com

Address: 2747 Lakeshore Drive, Twin Lake, MI 49457



High School District: Chippewa Hills

Miscellaneous

CrossStreet: 7 mile/10th **Listing Terms:** Cash, FHA, VA Loan, Conventional

Call us now