

744814, WOODLAWN, GRAND HAVEN, MI, 49417

https://tuckerbenner.com

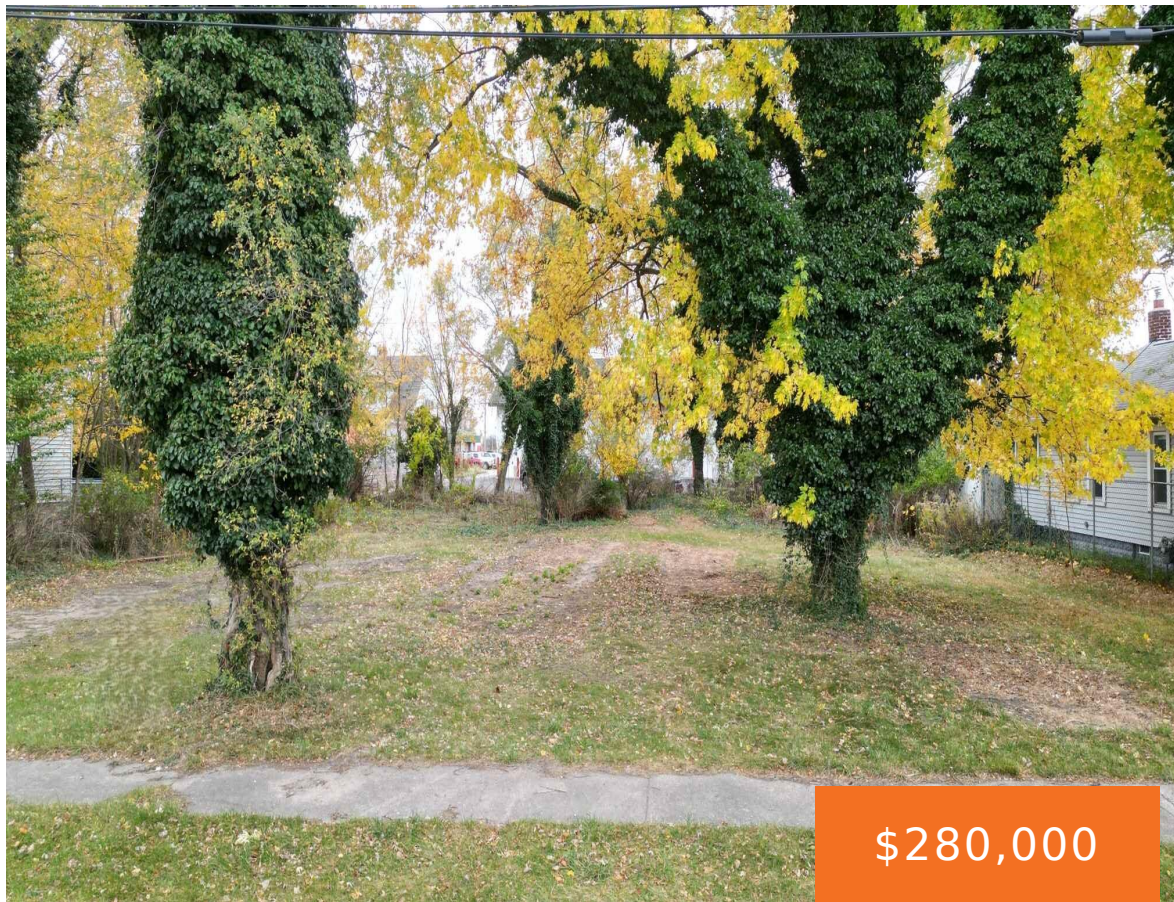

\$280,000



Prime development opportunity in the heart of downtown Grand Haven! This nearly half-acre property, located just off US-31, includes two parcels offering endless potential. One parcel offers a currently rented home, providing immediate rental income, while the other is vacant land, ideal for various commercial uses including Live Work Dwelling, toy barns and office space. [...]

- 1 bath
- Industrial
- Commercial Sale
- Active

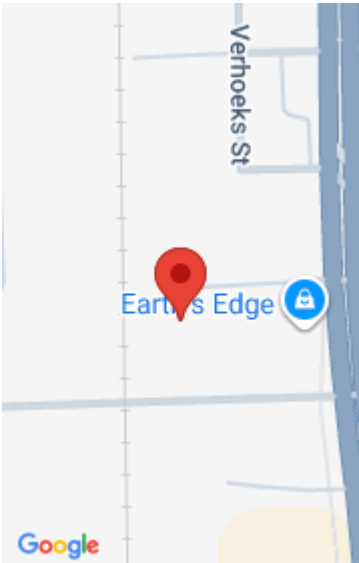

Call us now

Phone: (231)730-8781  
Email: tuckerbennerteam@gmail.com  
Address: 2747 Lakeshore Drive, Twin Lake, MI 49457

# Basics

**Category:** Commercial Sale

**Status:** Active

**Lot size:** 0.18 sq ft

**Bathrooms Full:** 1

**Business Type:** Other, Auto Service, Professional/Office, Professional Service, Restaurant, Distribution, Bar/Tavern/Lounge, Storage, Retail, Manufacturing, Institutional

**Type:** Industrial

**Bathrooms:** 1 bath

**Year built:** 1920

**Lot Size Acres:** 0.18 acres

**County:** Ottawa

# Building Details

**Building Area Total:** 19950 sq ft

**Construction Materials:** Vinyl Siding

**Heating:** Forced Air

**Building Features:** Fenced Storage

**Foundation Details:** Block

**Number Of Units Total:** 1

**Sewer:** Public Sewer

**StoriesTotal:** 1

**Roof:** Composition

**Number Of Buildings:** 1

# Amenities & Features

**Inclusions:** Real Estate

**Utilities:** Phone Available, Natural Gas Available, Electricity Available, Cable Available, Natural Gas Connected, Electricity Connected, Cable Connected, Sewer Available

**WaterSource:** Public

**Cooling:** Central Air

# Fees & Taxes

**Tax Assessed Value:** \$113,856

**Tax Year:** 2024

**Tax Annual Amount:** \$3,258

Call us now

---

# School Information

**High School District:** Grand Haven

---

# Miscellaneous

**CrossStreet:** US-31 and Dead End

**Listing Terms:** Conventional,  
Other, Cash

**Tenant Pays:** Electricity, Gas, Sewer, Trash Collection,  
Water

**Call us now**