

7509, GENESEE, LITCHFIELD, MI, 49252

<https://tuckerbenner.com>

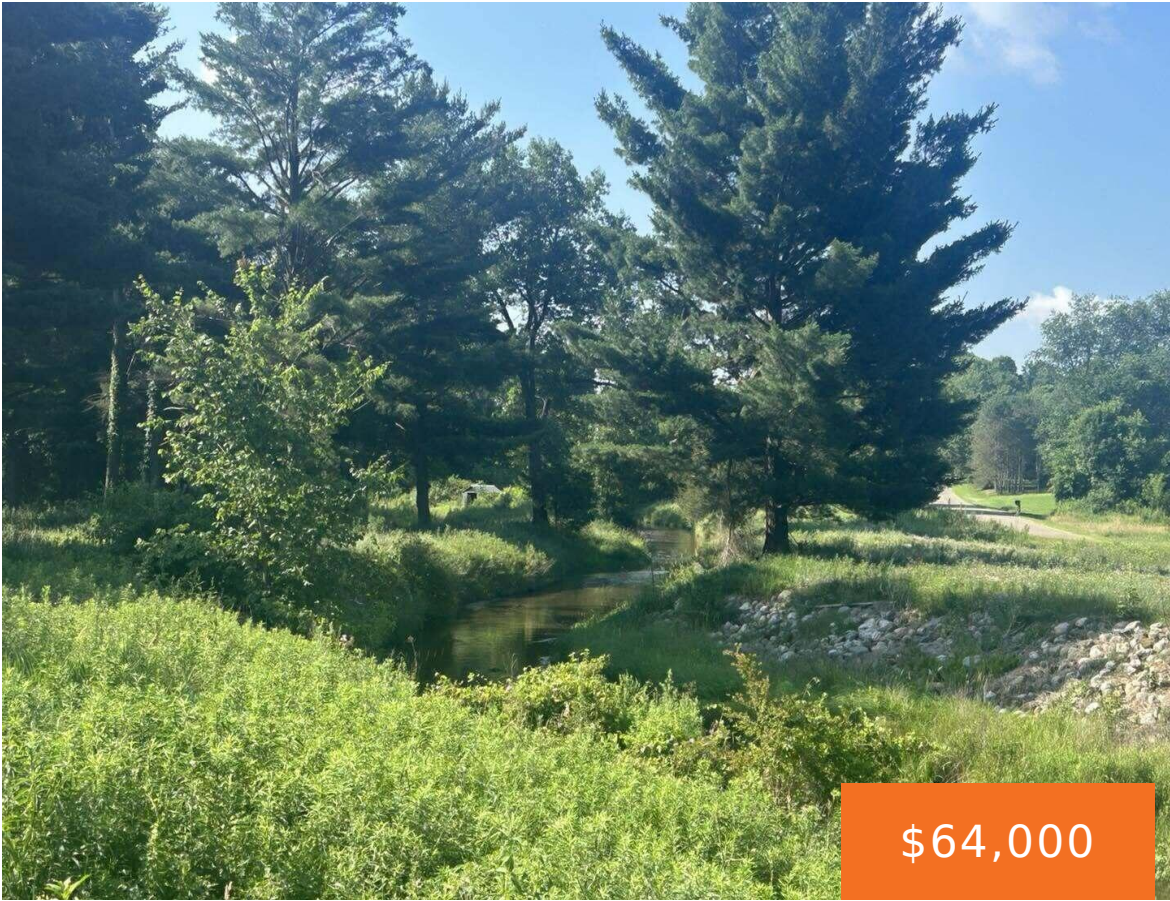

5.8 acres! A beautiful parcel that is mostly wooded, with water and a couple of build sites that have already been perked. If you're looking for a great spot to build your dream home, or a quiet place to park your camper and enjoy the outdoors, or even bow hunt during hunting season - This [...]

- 0 baths
- Lot
- Land
- Active



Basics

Category: Land

Status: Active

Lot size: 5.85 sq ft

County: Hillsdale

Type: Lot

Bathrooms: 0 baths

Lot Size Acres: 5.85 acres

Call us now



Phone: (231)730-8781

Email: tuckerbennerteam@gmail.com

Address: 2747 Lakeshore Drive, Twin Lake, MI 49457



Amenities & Features

Utilities: None

Waterfront Features: Stream/Creek

Lot Features: Buildable, Cleared, Wooded

Fees & Taxes

Tax Assessed Value: \$5,439

Tax Year: 2020

Tax Annual Amount: \$734.81

School Information

High School District: Litchfield

Miscellaneous

Road Surface Type: Paved

CrossStreet: Anderson & Genesee Rd.

Listing Terms: Cash, Conventional

Call us now



Phone: (231)730-8781

Email: tuckerbennerteam@gmail.com

Address: 2747 Lakeshore Drive, Twin Lake, MI 49457

