

# 775, CHLOE JANE, PORTAGE, MI, 49024

<https://tuckerbenner.com>

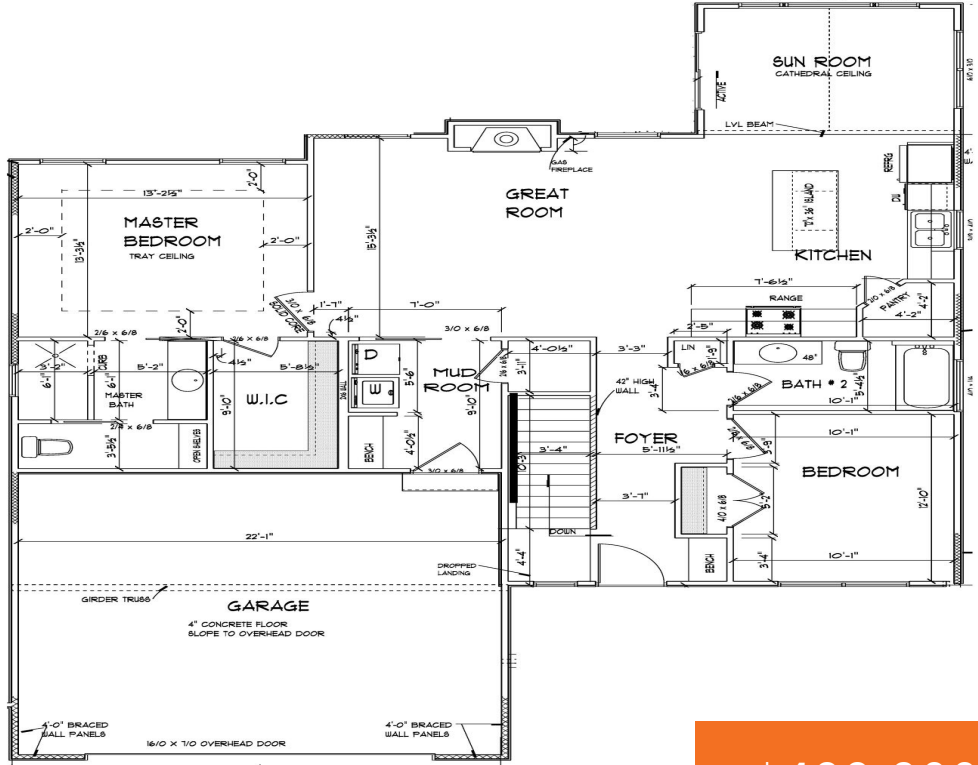

1,3 **\$499,900**

Welcome to Streamsong Condos—where your neighbors aren't just a wall away, but a yard apart! The final phase is now open, featuring stunning wooded lots—hurry, they're selling fast! Choose from several thoughtfully designed floor plans, each customizable to reflect your unique style and needs. Every condo is expertly crafted by TMR Builders, ensuring quality and attention [...]

- 2 beds
- 2 baths
- Condominium
- Residential
- Active
- 1380 sq ft



## Call us now

Phone: (231)730-8781  
Email: [tuckerbennerteam@gmail.com](mailto:tuckerbennerteam@gmail.com)  
Address: 2747 Lakeshore Drive, Twin Lake, MI 49457



---

## Basics

**Category:** Residential

**Status:** Active

**Bathrooms:** 2 baths

**Lot size:** 0 sq ft

**Subdivision Name:** Streamsong Condominiums

**Lot Size Acres:** 0 acres

**County:** Kalamazoo

**Type:** Condominium

**Bedrooms:** 2 beds

**Area:** 1380 sq ft

**Year built:** 2025

**Bathrooms Full:** 2

**Rooms Total:** 8

---

## Building Details

**Building Area Total:** 1380 sq ft

**Architectural Style:** Craftsman, Ranch

**Heating:** Forced Air

**Roof:** Composition

**Construction Materials:** Vinyl Siding

**Sewer:** Public

**Stories:** 1

**Basement:** Full

---

## Amenities & Features

**Laundry Features:** Electric Dryer Hookup, Gas Dryer Hookup, Laundry Room, Main Level, Washer Hookup

**Association Amenities:** Clubhouse, Pool

**Fireplace Features:** Living Room

**WaterSource:** Public

**Patio And Porch Features:** Patio, Porch(es)

**Cooling:** Central Air

**Flooring:** Tile, Wood

**Parking Features:** Garage Faces Front, Garage Door Opener, Attached

**Garage Spaces:** 2

**Interior Features:** Ceiling Fan(s), Garage Door Opener, Center Island, Eat-in Kitchen, Pantry

**Fireplaces Total:** 1

### Call us now



Phone: (231)730-8781

Email: tuckerbennerteam@gmail.com

Address: 2747 Lakeshore Drive, Twin Lake, MI 49457



---

## Fees & Taxes

**Tax Assessed Value:** \$1,343    **Association Fee Frequency:** Monthly

**Association Fee:** \$295    **Tax Year:** 2024

**Tax Annual Amount:** \$84.34    **Association Fee Includes:** Other, Trash, Snow Removal, Lawn/Yard Care

---

## School Information

**High School District:** Portage

---

## Miscellaneous

**Road Surface Type:** Paved

**CrossStreet:** Gracie Lane & Sharon Lee Lane

**Listing Terms:** Cash, Conventional

### Call us now



Phone: (231)730-8781

Email: tuckerbennerteam@gmail.com

Address: 2747 Lakeshore Drive, Twin Lake, MI 49457

