

7878, TERRITORIAL, DEXTER, MI, 48130

<https://tuckerbenner.com>

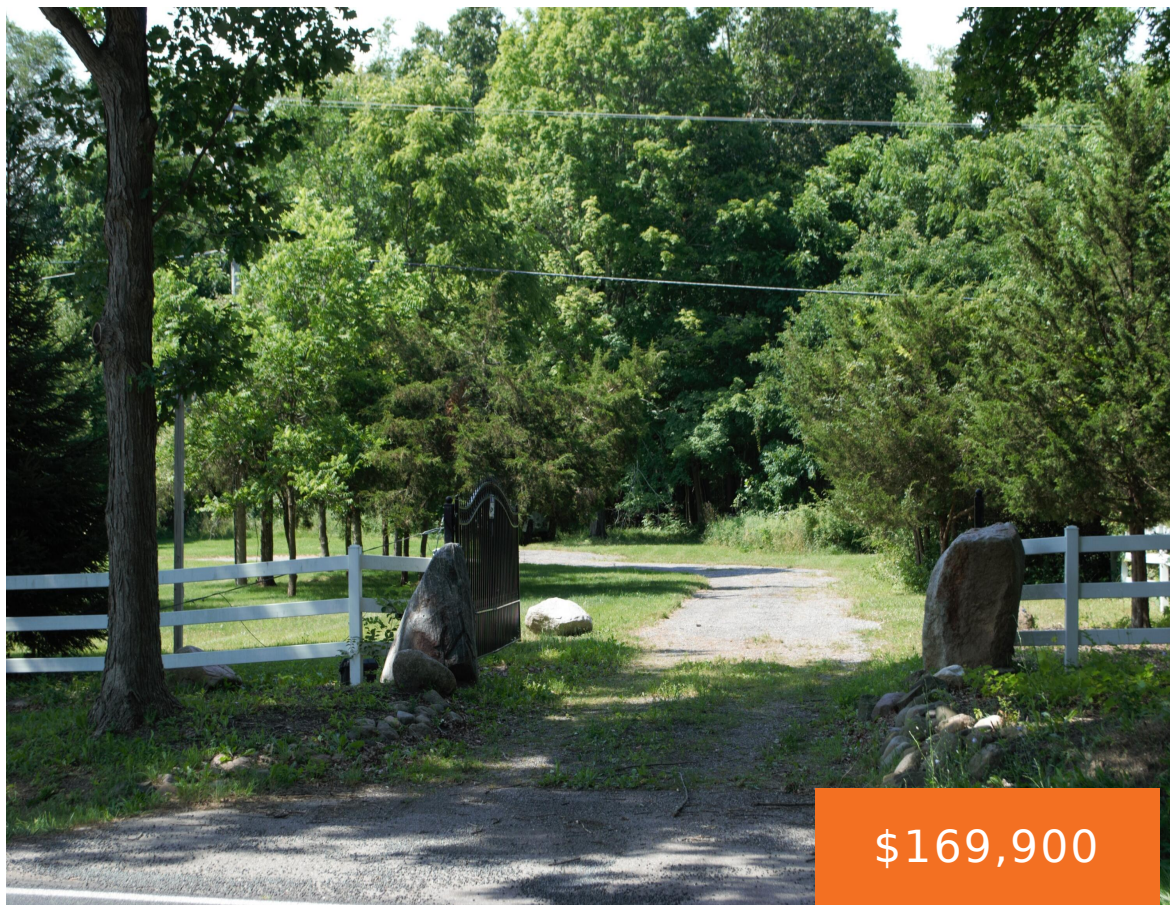

\$169,900



Tap your own Maple trees on this historic site located just 5 minutes into the charming City of Dexter and only 20 minutes into Ann Arbor. Towering Maples, Hickory, Cherry, and Oak welcome you home to this lovely setting where scenes of nature and wildlife await. With a beautifully completed gated entryway featuring boulders, white [...]

- 0 baths
- Lot
- Land
- Active



Basics

Category: Land

Status: Active

Lot size: 2.56 sq ft

County: Washtenaw

Type: Lot

Bathrooms: 0 baths

Lot Size Acres: 2.56 acres



Call us now

Phone: (231)730-8781
 Email: tuckerbennerteam@gmail.com
 Address: 2747 Lakeshore Drive, Twin Lake, MI 49457



Building Details

Current Use: Residential

Amenities & Features

Utilities: Natural Gas Available, Electricity Available, Cable Available, None

Lot Features: Ravine, Rolling Hills, Buildable, Wooded

Fees & Taxes

Tax Assessed Value: \$37,380

Tax Year: 2024

Tax Annual Amount: \$1,946.39

School Information

High School District: Dexter

Miscellaneous

Road Surface Type: Paved

CrossStreet: Huron River Dr & N Territorial

Listing Terms: Cash, Conventional



Call us now

Phone: (231)730-8781

Email: tuckerbennerteam@gmail.com

Address: 2747 Lakeshore Drive, Twin Lake, MI 49457

