

# 7888, TERRITORIAL, DEXTER, MI, 48130

<https://tuckerbenner.com>

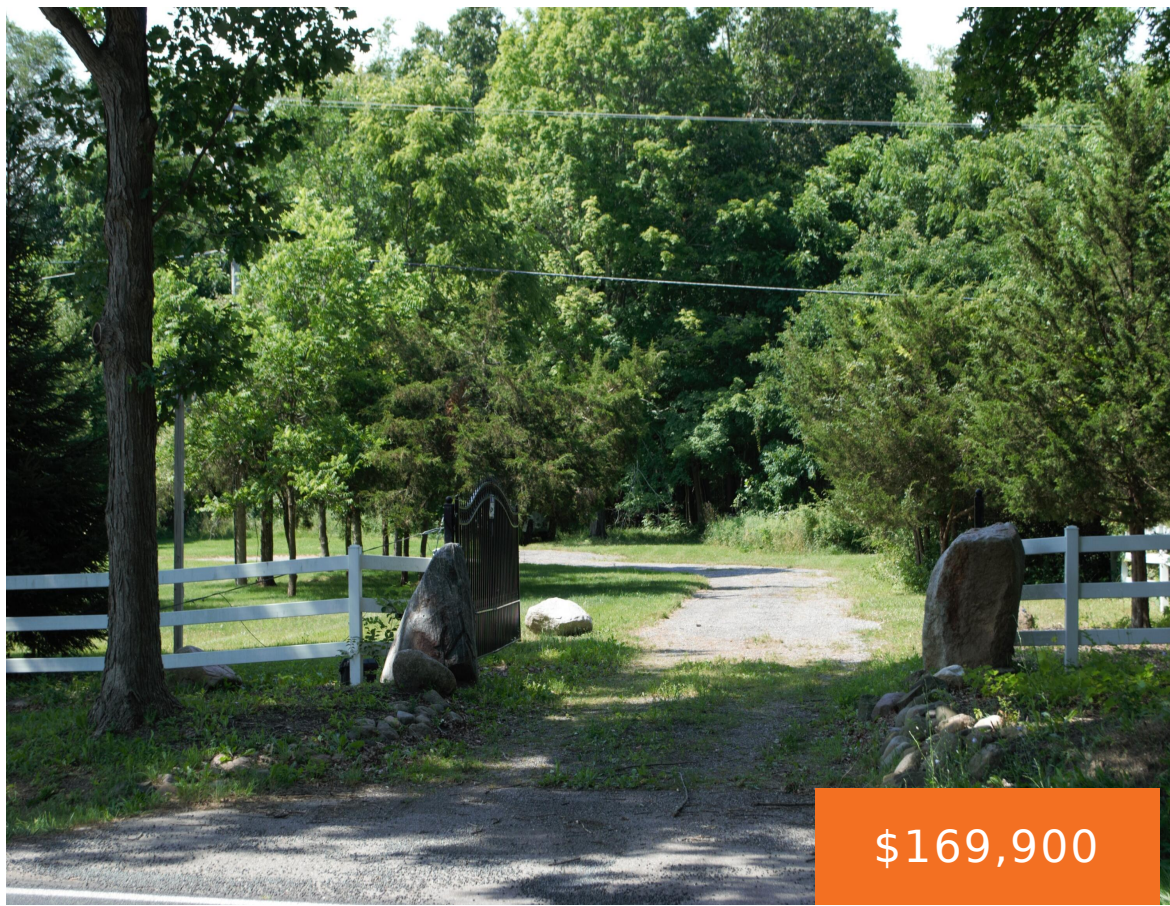

**\$169,900**



Tap your own Maple trees on this historic site located just 5 minutes into the charming City of Dexter and only 20 minutes into Ann Arbor. Towering Maples, Hickory, Cherry, and Oak welcome you home to this lovely setting where scenes of nature and wildlife await. With a beautifully completed gated entryway featuring boulders, white [...]

- 0 baths
- Lot
- Land
- Active



## Basics

**Category:** Land

**Status:** Active

**Lot size:** 2.04 sq ft

**County:** Washtenaw

**Type:** Lot

**Bathrooms:** 0 baths

**Lot Size Acres:** 2.04 acres



### Call us now

Phone: (231)730-8781

Email: [tuckerbennerteam@gmail.com](mailto:tuckerbennerteam@gmail.com)

Address: 2747 Lakeshore Drive, Twin Lake, MI 49457



---

## Amenities & Features

**Utilities:** Natural Gas Available, Electricity Available, Cable Available, None

**Lot Features:** Ravine, Rolling Hills, Buildable, Wooded

---

## Fees & Taxes

**Tax Assessed Value:** \$36,750

**Tax Year:** 2024

**Tax Annual Amount:** \$1,913

---

## School Information

**High School District:** Dexter

---

## Miscellaneous

**Road Surface Type:** Paved

**CrossStreet:** Huron River Dr & N Territorial

**Listing Terms:** Cash, Conventional



### Call us now

Phone: (231)730-8781

Email: [tuckerbennerteam@gmail.com](mailto:tuckerbennerteam@gmail.com)

Address: 2747 Lakeshore Drive, Twin Lake, MI 49457

