

# 7920, SIERRA, BELDING, MI, 48809

<https://tuckerbenner.com>

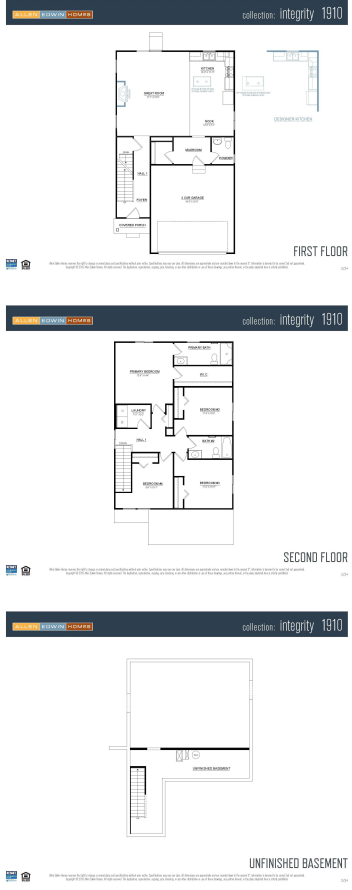

New construction home in Ellis Acres, located in Belding school district. RESNET energy smart construction will save owner over \$1000 yearly plus home has 10-year structural warranty! Welcome home to over 1900 sq. ft. of living space on 2 levels that combine function and style. Starting at the covered porch leading into the foyer, down [...]

- 4 beds
- 3 baths
- Single Family Residence
- Residential
- Active
- 1909 sq ft



## Basics



### Call us now

Phone: (231)730-8781  
Email: [tuckerbennerteam@gmail.com](mailto:tuckerbennerteam@gmail.com)  
Address: 2747 Lakeshore Drive, Twin Lake, MI 49457



**Category:** Residential

**Status:** Active

**Bathrooms:** 3 baths

**Lot size:** 0.64 sq ft

**Subdivision Name:** Ellis Acres

**Lot Size Acres:** 0.64 acres

**County:** Ionia

**Type:** Single Family Residence

**Bedrooms:** 4 beds

**Area:** 1909 sq ft

**Year built:** 2024

**Bathrooms Full:** 2

**Rooms Total:** 9

**Bathrooms Half:** 1

---

## Building Details

**Building Area Total:** 1909 sq ft

**Architectural Style:** Colonial

**Heating:** Forced Air

**Basement:** Full

**Construction Materials:** Vinyl Siding

**Sewer:** Septic Tank

**Stories:** 2

---

## Amenities & Features

**Laundry Features:** Laundry Room, Upper Level

**Parking Features:** Garage Faces Front, Garage Door Opener, Attached

**WaterSource:** Well

**Interior Features:** Garage Door Opener, Kitchen Island, Eat-in Kitchen

**Exterior Features:** Porch(es), Patio

**Utilities:** Natural Gas Connected

**Garage Spaces:** 2

**Appliances:** Washer, Refrigerator, Range, Microwave, Dryer, Dishwasher

**Window Features:** Low-Emissivity Windows, Screens

**Cooling:** SEER 13 or Greater, Central Air

---

## Fees & Taxes

**Tax Assessed Value:** \$1,680

**Association Fee:** \$160

**Tax Annual Amount:** \$81.87

**Association Fee Frequency:** Quarterly

**Tax Year:** 2024

**Association Fee Includes:** Other



### Call us now

Phone: (231)730-8781

Email: tuckerbennerteam@gmail.com

Address: 2747 Lakeshore Drive, Twin Lake, MI 49457



---

## School Information

**High School District:** Belding

---

## Miscellaneous

**Road Surface Type:** Paved

**CrossStreet:** M-91

**Listing Terms:** Cash, FHA, VA Loan, Rural Development, MSHDA, Conventional



### Call us now

Phone: (231)730-8781

Email: [tuckerbennerteam@gmail.com](mailto:tuckerbennerteam@gmail.com)

Address: 2747 Lakeshore Drive, Twin Lake, MI 49457

